

1 Location of Well
 County INGHAM Township Name DELHI Fraction SE 1/4 NE 1/4 SE 1/4 Section Number 13 Town Number T3N Range Number N/S R2W E/W

Distance and Direction From Road Intersection
110' WEST OF COLLEGE RD (2191)
3/10THS MILE NORTH OF HOLT RD
COLLEGE RD (2191)
HOLT

3 Owner of Well TUNKS, TIM
 Address 2191 COLLEGE
HOLT MI 48842-
 Address Same as Well Location? Yes

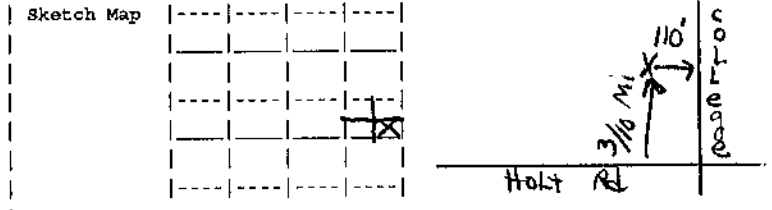

4 Well Depth (Completed) 100 ft. Date of Completion 09/18/98
 Replacement Well
 5 Drilling Method ROTARY
 6 Proposed Use DOMESTIC

2 FORMATION DESCRIPTION

FORMATION DESCRIPTION	Thickness of Stratum	Depth to Bottom of Stratum
TOPSOIL	02	02
BROWN CLAY	11	13
GRAVEL	03	16
BROWN CLAY	12	28
GRAVEL	03	31
SANDSTONE GRAY SHALE	69	100

7 Casing PLASTIC SDR 21 Height Above Surface 1.5 ft.
5 in. to 54 ft. depth Weight 2.87 lbs./ft.
 Bore Hole Diameter
8 3/4 in. to 52.5 ft. depth Drive Shoe Yes
 Shale Packer No
 8 Screen Not Installed Gravel-packed? No
 9 Static Water Level 22 Ft. Below Land Surface Flo
 10 Pumping Level Below Land Surface
40 ft. after hrs. pumping at 30 G.P.M.
ft. after hrs. pumping at G.P.M.
 Using AIR
 11 Well Head Completion PITLESS ADAPTER
 12 Well Grouted? Yes From 52 to 0 ft.
BENSEAL
 No. of bags 5 Additives
 13 Nearest Source of Possible Contamination
SEPTIC TANK Distance 50+ ft. Direction W
 Distance ft. Direction

15 Abandoned well plugged? Yes
 Casing Diameter 2 in. Depth 85 ft.
 Plugging material: CEMENT
 No. of bags 2 Casing removed? No

14 Pump Installed Yes Pump Installation Only? No
 Manufacturer's Name GOULDS
 Model Number 10LS05422 HP 1/2 Volts 230
 Length of Drop Pipe 40 ft. Capacity 10 G.P.M.
 Type SUBMERSIBLE Jet
 Pressure tank:
 Manufacturer's Name
 Pressure Tank Model Capacity 0 gal.

16 Remarks, elevation, source of data, etc.
 17 Drilling machine operator:
 Employee
 Name RON MCORIMMON
 Authority: Act 368 PA 1978
 Completion: Required.
 Penalty: Conviction of violation of any provision is a misdemeanor.
 IMPORTANT: File with deed.

18 Water Well Contractor's Certification:
 This well was drilled under my jurisdiction and this report is true to the best of my knowledge and belief.
 Registered business name: HART WELL DRILLING CO.
 Registration number: 1686
 Address: 1154 SOUTH JEFFERSON, MASON, MI 48854
 Signed: David W. Hart Date 9/25/98
 (Authorized representative)

WATER WELL AND PUMP RECORD

1
0
2
3
8
7
6
4
2
PERMIT NUMBER

1 LOCATION OF WELL		Fraction	Section Number	Town Number	Range Number
County Ingham	Township Name Delhi	SE 1/4 NE 1/4 SE 1/4	13	T3N N/S	R2W E/W

Distance And Direction From Road Intersection
**West side of College Road
2 1/2 tenths North of Holt Road**

Street Address & City of Well Location
Locate with "X" in Section Below

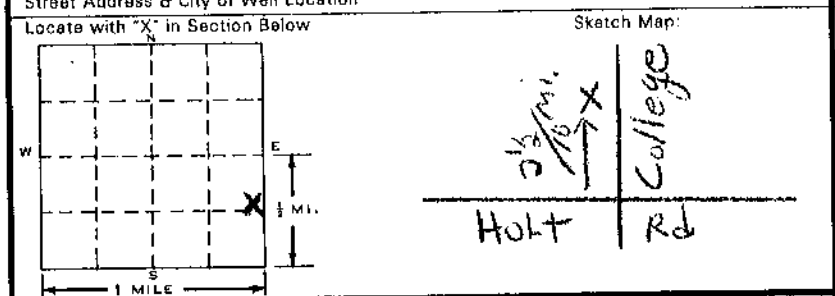

3 OWNER OF WELL: Donald McDaniel
2125 College Road
Holt, MI 48842

Address Same As Well Location? Yes No

4 WELL DEPTH: 80 FT. Date Completed **8 31 89**
 New Well
 Replacement Well

5 Cable tool Rotary Driven Dug
 Hollow rod Auger Jetted

6 USE: Domestic Type I Public Type III Public
 Irrigation Type IIa Public Heat pump
 Test Well Type IIb Public

7 CASING: Steel Threaded Height: Above/Surface **14" x**
 PVC Plastic Welded **2.87 lbs./ft.**
5 in. to **37** ft. depth
 in. to _____ ft. depth
 Grouped Drill Hole Diameter **7 7/8 in. 35' 10"**
 in. to _____ ft. depth
 Drive Shoe Yes No

2 FORMATION DESCRIPTION	THICKNESS OF STRATUM	DEPTH TO BOTTOM OF STRATUM
Brown Gritty Clay	8	8
Gravel	11	19
Gravel & Gray Clay	11	30
Soft GRay Sandstone	5	35
Gray Sandstone	22	57
Brown Lime	10	67
White Sandstone	13	80

8 SCREEN: Not Installed
 Type _____ Diameter _____
 Slot/Gauze _____ Length _____
 Set between _____ ft. and _____ ft.
FITTINGS: K-Packer Lead Packer Bremer Check
 Blank above screen _____ ft. Other _____

9 STATIC WATER LEVEL: **15** ft. below land surface Flow

10 PUMPING LEVEL: below land surface
40 ft. after _____ hrs. pumping at **40** G.P.M. **w/air**
 _____ ft. after _____ hrs. pumping at _____ G.P.M.

11 WELL HEAD COMPLETION: Pitless adapter 12" above grade
 Basement offset Approved pit

12 WELL GROUTED? No Yes From _____ to _____ ft.
 Neat cement Bentonite Other _____
 No. of bags of cement _____ Additives _____

13 Nearest source of possible contamination
 Type _____ Distance _____ ft. Direction _____
 Well disinfected upon completion? Yes No
 Was old well plugged? Yes No

14 PUMP: Not Installed Pump Installation Only
 Manufacturer's name **Tael (owners)**
 Model number _____ HP **1** Volts _____
 Length of Drop Pipe **30** ft. capacity _____ G.P.M.
 TYPE: Submersible Jet
PRESSURE TANK:
 Manufacturer's name **Amtrol**
 Model number **WX-251** Capacity **62** Gallons

15. Remarks, elevation, source of data, etc.
OCT 23 1989
RECEIVED
 (Mich. Dept. of Public Health)
 USE A 2ND SHEET IF NEEDED

17. Rig Operator's Name:
Winfield Fell

16. WATER WELL CONTRACTOR'S CERTIFICATION:
 This well was drilled under my jurisdiction and this report is true to the best of my knowledge and belief.
Hart Well Drilling Company 1686
 REGISTERED BUSINESS NAME REGISTRATION NO.
 Address **1154 S. Jefferson St. Mason, MI 48854**
 Signed **[Signature]** Date **9/11/89**
 AUTHORIZED REPRESENTATIVE

Authority: Act 368 PA 1978
 Completion: Required
 Penalty: Conviction of a violation of any provision is a misdemeanor.

WATER WELL AND PUMP RECORD

10 58 7 5 9 6
PERMIT NUMBER

1 LOCATION OF WELL		3 OWNER OF WELL:																												
County Ingham	Township Name Delhi	Fraction NE 1/4 NE 1/4 SE 1/4	Section Number 13																											
Distance And Direction From Road Intersection 160' West of College Road 4/10ths Mile North of Holt Road		Town Number T3N (N)S																												
Street Address & City of Well Location Locate with "X" in Section Below		Range Number R2W E(W)																												
<div style="display: flex; align-items: center;"> <div style="flex: 1;"> </div> <div style="flex: 1;"> <p style="text-align: center;">Sketch Map:</p> <p style="text-align: center;">160' 4/10 mi. X College Rd Holt Rd</p> </div> </div>		Address 2207 College Road Holt, MI 48842																												
<table border="1" style="width: 100%; border-collapse: collapse;"> <tr> <td style="text-align: center;">2 FORMATION DESCRIPTION</td> <td style="text-align: center;">THICKNESS OF STRATUM</td> <td style="text-align: center;">DEPTH TO BOTTOM OF STRATUM</td> </tr> <tr> <td>Brown Gritty Clay</td> <td style="text-align: center;">19</td> <td style="text-align: center;">19</td> </tr> <tr> <td>Gray Gritty Clay</td> <td style="text-align: center;">19</td> <td style="text-align: center;">(38)</td> </tr> <tr> <td>Soft White Sandstone</td> <td style="text-align: center;">8</td> <td style="text-align: center;">46</td> </tr> <tr> <td>Soft Black Shale & Soft White S.S.</td> <td style="text-align: center;">10</td> <td style="text-align: center;">56</td> </tr> <tr> <td>Brown Lime Stone</td> <td style="text-align: center;">3</td> <td style="text-align: center;">59</td> </tr> <tr> <td>Hard Gray Shale</td> <td style="text-align: center;">1</td> <td style="text-align: center;">60</td> </tr> <tr> <td>Hard Gray S.S. & Soft Gray S.S.</td> <td style="text-align: center;">6</td> <td style="text-align: center;">66</td> </tr> <tr> <td>Gray S.S. w/Strips of Brn Lime & Black Shale</td> <td style="text-align: center;">49</td> <td style="text-align: center;">115</td> </tr> </table>		2 FORMATION DESCRIPTION	THICKNESS OF STRATUM	DEPTH TO BOTTOM OF STRATUM	Brown Gritty Clay	19	19	Gray Gritty Clay	19	(38)	Soft White Sandstone	8	46	Soft Black Shale & Soft White S.S.	10	56	Brown Lime Stone	3	59	Hard Gray Shale	1	60	Hard Gray S.S. & Soft Gray S.S.	6	66	Gray S.S. w/Strips of Brn Lime & Black Shale	49	115	Date of Completion 10-16-87	
		2 FORMATION DESCRIPTION	THICKNESS OF STRATUM	DEPTH TO BOTTOM OF STRATUM																										
Brown Gritty Clay	19	19																												
Gray Gritty Clay	19	(38)																												
Soft White Sandstone	8	46																												
Soft Black Shale & Soft White S.S.	10	56																												
Brown Lime Stone	3	59																												
Hard Gray Shale	1	60																												
Hard Gray S.S. & Soft Gray S.S.	6	66																												
Gray S.S. w/Strips of Brn Lime & Black Shale	49	115																												
Address Same As Well Location? <input checked="" type="checkbox"/> Yes <input type="checkbox"/> No		Address Same As Well Location? <input checked="" type="checkbox"/> Yes <input type="checkbox"/> No																												
		Address Same As Well Location? <input checked="" type="checkbox"/> Yes <input type="checkbox"/> No																												
5 <input type="checkbox"/> Cable tool <input checked="" type="checkbox"/> Rotary <input type="checkbox"/> Driven <input type="checkbox"/> Dug <input type="checkbox"/> Hollow rod <input type="checkbox"/> Auger <input type="checkbox"/> Jetted <input type="checkbox"/>		4 WELL DEPTH: (completed) 115 ft.																												
		6 USE: <input checked="" type="checkbox"/> Domestic <input type="checkbox"/> Type I Public <input type="checkbox"/> Type III Public <input type="checkbox"/> Irrigation <input type="checkbox"/> Type IIa Public <input type="checkbox"/> Heat pump <input type="checkbox"/> Test Well <input type="checkbox"/> Type IIb Public <input type="checkbox"/>																												
7 CASING: <input type="checkbox"/> Steel <input type="checkbox"/> Threaded <input type="checkbox"/> Welded Diameter PVC 5 in. to 60 ft. depth <input checked="" type="checkbox"/> Plastic <input checked="" type="checkbox"/> Grouted Drill Hole Diameter 8 7/8 in. to 58 ft. depth		Height: Above/Below Surface 18" ft. Weight 2.87 lbs./ft.																												
		Drive Shoe <input checked="" type="checkbox"/> Yes <input type="checkbox"/> No																												
8 SCREEN: <input checked="" type="checkbox"/> Not Installed Type _____ Diameter _____ Slot/Gauze _____ Length _____ Set between _____ ft. and _____ ft. FITTINGS: <input type="checkbox"/> K-Packer <input type="checkbox"/> Lead Packer <input type="checkbox"/> Bromer Check <input type="checkbox"/> Blank above screen _____ ft. Other _____		9 STATIC WATER LEVEL: 23 ft. below land surface <input type="checkbox"/> Flow																												
		10 PUMPING LEVEL: below land surface 40 ft. after _____ hrs. pumping at 15 G.P.M. w/air _____ ft. after _____ hrs. pumping at _____ G.P.M.																												
11 WELL HEAD COMPLETION: <input checked="" type="checkbox"/> Pitless adapter <input type="checkbox"/> 12" above grade <input type="checkbox"/> Basement offset <input type="checkbox"/> Approved pit		12 WELL GROUTED? <input type="checkbox"/> No <input checked="" type="checkbox"/> Yes From _____ to _____ ft. <input type="checkbox"/> Neat cement <input checked="" type="checkbox"/> Bentonite <input type="checkbox"/> Other _____ No. of bags of cement _____ Additives _____																												
		13 Nearest source of possible contamination Type _____ Distance _____ ft. Direction _____ Well disinfected upon completion? <input checked="" type="checkbox"/> Yes <input type="checkbox"/> No																												
14 PUMP <input type="checkbox"/> Not installed <input type="checkbox"/> Pump Installation Only Manufacturer's name Gould Model number 10EJ05422 HP 1/2 Volts 230 Length of Drop Pipe 40 ft. capacity 10 G.P.M. TYPE: <input checked="" type="checkbox"/> Submersible <input type="checkbox"/> Jet _____ PRESSURE TANK: Manufacturer's name _____ Model number _____ Capacity _____ Gallons		15. Remarks, elevation, source of data, etc.																												
		16. WATER WELL CONTRACTOR'S CERTIFICATION: This well was drilled under my jurisdiction and this report is true to the best of my knowledge and belief. Hart Well Drilling Co. 1686 REGISTERED BUSINESS NAME REGISTRATION NO. Address 154 S. Jefferson St. Mason, MI 48854 Signed <i>David W. Hart</i> Date 10-20-87 AUTHORIZED REPRESENTATIVE																												

RECEIVED
Mich. Dept. of Public Health
OCT 22 1987
Bureau of Environmental and Occupational Health - GWOS

JUN 21 1977



S/N 4977-2

Invoice # 2000

WATER WELL RECORD
ACT 294 PA 1965

MICHIGAN DEPARTMENT
OF
PUBLIC HEALTH

1 LOCATION OF WELL			
County Ingham	Township Name Dalhi	Fraction SE 1/4 NE 1/4 W 1/2	Section Number 13 Town Number T3N N/S. Range Number R2W E/W.

Distance and Direction from Road Intersections
2401 Valtema Drive, Willoughby Heights
2, Holt, Michigan Lot #26

3 OWNER OF WELL:
Corneal Valtema
 Address **3805 Willoughby Road**
Holt, Michigan 48842

Street address & City of Well Location
 Locate with "X" in section below

4 WELL DEPTH: (completed) **115'** ft. Date of Completion **4-7-77**

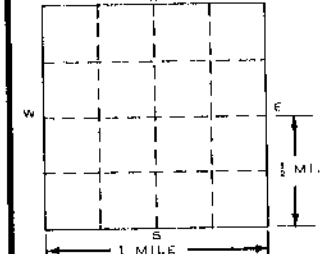

Sketch Map:

5 Cable tool Rotary Driven Dug
 Hollow rod Jotted Bored

2 FORMATION

FORMATION	THICKNESS OF STRATUM	DEPTH TO BOTTOM OF STRATUM
Sand & gravel		65
Soft rock		77
Rock		115

6 USE: Domestic Public Supply Industry
 Irrigation Air Conditioning Commercial
 Test Well

7 CASING: Threaded Welded Height: Above/Below Surface **1** ft.
 Weight **11** lbs./ft. Drive Shoe? Yes No

8 SCREEN:
 Type: _____ Dia.: _____
 Slot/Gauze _____ Length _____
 Set between _____ ft. and _____ ft.
 Fittings: _____

9 STATIC WATER LEVEL
25 ft. below land surface

10 PUMPING LEVEL below land surface
 _____ ft. after _____ hrs. pumping **30** g.p.m.
 _____ ft. after _____ hrs. pumping _____ g.p.m.

11 WATER QUALITY in Parts Per Million:
 Iron (Fe) _____ Chlorides (Cl) _____
 Hardness _____ Other _____

12 WELL HEAD COMPLETION: In Approved Pit
 Pitless Adapter 12" Above Grade

13 Well Grouted? Yes No
 Neat Cement Bentonite _____
 Depth: From _____ ft. to _____ ft.

14 Nearest Source of possible contamination
 _____ foot Direction _____ Type _____
 Well disinfected upon completion Yes No

15 PUMP: Not installed
 Manufacturer's Name **Aermotor** **SDB**
 Model Number **3W230V8GPM** HP. **1/2** Volts **230**
 Length of Drop Pipe **60** ft. capacity **30** G.P.M.
 Type: Submersible Jet Reciprocating

16 Remarks, elevation, source of data, etc.

ADDED INFO BY DRILLER, ITEM NO. _____
 *CORRECTED BY **VT**
 **ADDITION BY _____
 ELEVATION _____
 DEPTH TO ROCK _____

17 WATER WELL CONTRACTOR'S CERTIFICATION:
 This well was drilled under my jurisdiction and this report is true to the best of my knowledge and belief.
Daily & Jackson Well Drilling **0390**
REGISTERED BUSINESS NAME REGISTRATION NO.
 Address **6534 Aureliud Rd., Lansing, Mi**
 Signed *Mary Shepherd* Date **48910-14-77**
AUTHORIZED REPRESENTATIVE

S/N7R77-3
Inv# 2046

DEC 15 1977

WATER WELL RECORD
ACT 294 PA 1965

MICHIGAN DEPARTMENT
OF
PUBLIC HEALTH



1 LOCATION OF WELL		Fraction	Section Number	Town Number	Range Number
County Ingham	Township Name Delhi	$\frac{1}{4}$ NE $\frac{1}{4}$ NW $\frac{1}{4}$	13	T3N N/S.	R2W E/W.

Distance And Direction from Road Intersections
Veltema Dr., Willoughby Hts. Subdv #2

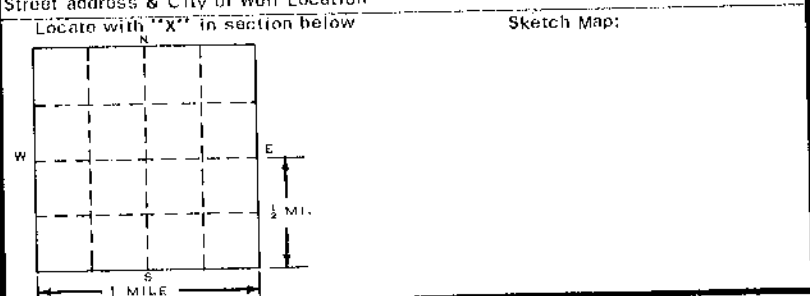

3 OWNER OF WELL:
Corneal Veltema
At **3805 Willoughby Rd.**
Holt, Mich 48842

4 WELL DEPTH: (completed) Date of Completion
110' ft. **7-8-77**

5 Cable tool Rotary Driven Dug
 Hollow rod Jetted Bored

6 USE: Domestic Public Supply Industry
 Irrigation Air Conditioning Commercial
 Test Well

7 CASING: Threaded Welded
Diam. _____ Height: Above/Below Surface **1** ft.
4 in. to **74** ft. Depth Weight **11** lbs./ft.
_____ in. to _____ ft. Depth Drive Shoe? Yes No

2 FORMATION	THICKNESS OF STRATUM	DEPTH TO BOTTOM OF STRATUM
Clay		10'
Water Sand		30'
Clay		40'
Hard Pan & Gravel		67'
Shale & Rock		80'
Rock		110'

8 SCREEN:
Type: _____ Dia.: _____
Slot/Gauze _____ Length _____
Set between _____ ft. and _____ ft.
Fittings: _____

9 STATIC WATER LEVEL
32 ft. below land surface

10 PUMPING LEVEL below land surface
_____ ft. after _____ hrs. pumping _____ g.p.m.
_____ ft. after _____ hrs. pumping **20** g.p.m.

11 WATER QUALITY in Parts Per Million:
Iron (Fe) _____ Chlorides (Cl) _____
Hardness _____ Other _____

12 WELL HEAD COMPLETION: In Approved Pit
 Pitless Adapter 12" Above Grade

13 Well Grouted? Yes No
 Neat Cement Bentonite
Depth: From _____ ft. to _____ ft.

14 Nearest Source of possible contamination
_____ feet _____ Direction _____ Type _____
Well disinfected upon completion Yes No

15 PUMP: Not installed
Manufacturer's Name **Aermotor**
Model Number **SD8-50** HP $\frac{1}{2}$ Volts **230**
Length of Drop Pipe **60** ft. capacity **20** G.P.M.
Type: Submersible Jet Reciprocating

16 Remarks, elevation, source of data, etc.
ELEVATION _____
DEPTH TO ROCK _____
DRAINED INFO BY DRILLER, ITEM NO. _____
CHECKED BY **VT**
DRAWN BY _____

17 WATER WELL CONTRACTOR'S CERTIFICATION:
This well was drilled under my jurisdiction and this report is true to the best of my knowledge and belief.
Daily & Jackson Well Drilling, Inc. 0390
REGISTERED BUSINESS NAME REGISTRATION NO.
Address **6534 S. Aurelius Rd., Lansing, Mi 48910**
Signed **Mary Shepherd** Date **7/21/77**
AUTHORIZED REPRESENTATIVE

NOV 10 1972

WATER WELL RECORD
ACT 294 PA 1965

MICHIGAN DEPARTMENT
OF
PUBLIC HEALTH

1 LOCATION OF WELL
 County: **Ingham** Township Name: **Delhi** Fraction: **NE 1/4 SE 1/4** Section Number: **13** Town Number: **3 N/B.** Range Number: **2 N/W.**

Distance And Direction from Road Intersections:
1/2 Mile North of Holt Rd.
200' West of College Rd. **College Rd.**
Holt Michigan

Street address & City of Well Location: **15480 Boishot Rd. Lansing Michigan 48906**

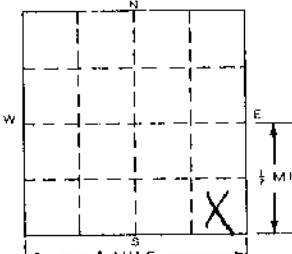
Locate with "X" in section below

 Sketch Map:

3 OWNER OF WELL:
Flositz & Rockwood
 Address: **15480 Boishot Rd. Lansing Michigan 48906**

4 WELL DEPTH: (completed) **125** ft. Date of Completion: **10-9-72**

5 Cable tool Rotary Driven Dug
 Hollow rod Jotted Bored

6 USE: Domestic Public Supply Industry
 Irrigation Air Conditioning Commercial
 Test Well

7 CASING: Threaded Welded Height: Above Surface **1** ft.
 Diam. **4** in. to **52** ft. Depth **11** lbs./ft.
 Drive Shoe? Yes No

2 FORMATION	THICKNESS OF STRATUM	DEPTH TO BOTTOM OF STRATUM
Sand & Clay	21	21
Clay & Gravel	22	43
Sandrock & Shale	83	125

8 SCREEN:
 Type: **None** Dia.: _____
 Slot/Gauzo _____ Length _____
 Set between _____ ft. and _____ ft.
 Fittings: _____

9 STATIC WATER LEVEL
13 ft. below land surface

10 PUMPING LEVEL below land surface
 _____ ft. after _____ hrs. pumping _____ g.p.m.
Not Required
 _____ ft. after _____ hrs. pumping _____ g.p.m.

11 WATER QUALITY in Parts Per Million:
 Iron (Fe) _____ Chlorides (Cl) _____
Not Required
 Hardness _____ Other _____

12 WELL HEAD COMPLETION: In Approved Pit
 Pitless Adapter 12" Above Grade

13 Well Grouted? Yes No
 Neat Cement Bentonite Bentonite
 Depth: From **0** ft. to **52** ft.

14 Nearest Source of possible contamination
50 feet **W** Direction **Septic** Type
 Well disinfected upon completion Yes No

15 PUMP: Not installed
 Manufacturer's Name: **Webtrol**
 Model Number: **102658** HP **1/2** Volts **230**
 Length of Drop Pipe: **42** ft. capacity **800** G.P.M.
 Type: Submersible Jet Reciprocating

16 Remarks, elevation, source of data, etc.
 USE A 2ND SHEET IF NECESSARY
ADDED INFO. BY DRILLER, ITEM NO.
CORRECTED BY:
DEFINITION BY:

17 WATER WELL CONTRACTOR'S CERTIFICATION:
 This well was drilled under my jurisdiction and this report is true to the best of my knowledge and belief.
Maurer & Parks Inc. **0383**
 REGISTERED BUSINESS NAME REGISTRATION NO.
 Address: **4700 N. East St. Lansing, Mich.**
 Signed: *Eugene Maurer* Date **10-11-72**
 AUTHORIZED REPRESENTATIVE

NOV 29 1972

WATER WELL RECORD
ACT 294 PA 1965

MICHIGAN DEPARTMENT
OF
PUBLIC HEALTH

1 LOCATION OF WELL
County **Ingham** Township Name **Delhi** Fraction **NE 1/4 SE 1/4 SE 1/4** Section Number **13** Town Number **3 N/2** Range Number **2 W.**

Distance And Direction from Road Intersections
**1/2 Mile North of Holt Rd.
200' West of College** **2089 College Rd.
Holt Michigan**

Street address & City of Well Location
Locate with "X" in section below Sketch Map:

2 FORMATION

FORMATION	THICKNESS OF STRATUM	DEPTH TO BOTTOM OF STRATUM
Sand & Clay	20	20
Clay & Gravel	22	42
Sand rock & Shale	83	125

3 OWNER OF WELL:
Flositz & Rockwood
Address **15480 Boichot Rd.
Lansing Michigan**

4 WELL DEPTH: (completed) Date of Completion
125 ft. **11-10-72**

5 Cable tool Rotary Driven Dug
 Hollow rod Jetted Bored

6 USE: Domestic Public Supply Industry
 Irrigation Air Conditioning Commercial
 Test Well

7 CASING: Threaded Welded Height: Above ~~XXXX~~
Diam. Surface **1** ft. Weight **11** lbs./ft.
4 in. to **52** ft. Depth Drive Shoe? Yes No

8 SCREEN:
Type: **None** Dia.: _____
Slot/Gauze _____ Length _____
Set between _____ ft. and _____ ft.
Fittings: _____

9 STATIC WATER LEVEL
13 ft. below land surface

10 PUMPING LEVEL below land surface
_____ ft. after _____ hrs. pumping _____ g.p.m.
Not Required
_____ ft. after _____ hrs. pumping _____ g.p.m.

11 WATER QUALITY in Parts Per Million:
Iron (Fe) _____ Chlorides (Cl) _____
Hardness _____ Other **Not Required**

12 WELL HEAD COMPLETION: In Approved Pit
 Pitless Adapter 12" Above Grade

13 Well Grouted? Yes No
 Neat Cement Bentonite **Bentonite**
Depth: From **0** ft. to **52** ft.

14 Nearest Source of possible contamination
50 feet **E** Direction **Septic** Type
Well disinfected upon completion Yes No

15 PUMP: Not installed
Manufacturer's Name **Webtrol**
Model Number **102858** HP **1/2** Volts **230**
Length of Drop Pipe **42** ft. capacity **800 G.P.H.**
Type: Submersible Jet Reciprocating

16 Remarks, elevation, source of data, etc.
ADDED INFO. BY DRILLER, **HEM**
CORRECTED BY **[Signature]**
REGISTRATION # **[Number]**

17 WATER WELL CONTRACTOR'S CERTIFICATION:
This well was drilled under my jurisdiction and this report is true to the best of my knowledge and belief.
Mayer & Parks Inc. REGISTRATION NO. **0983**
Address **4700 N. East St. Lansing, Mich.**
Signed **[Signature]** Date **11-22-72**
AUTHORIZED REPRESENTATIVE

#615

WATER WELL RECORD
ACT 294 PA 1965

MICHIGAN DEPARTMENT
OF
PUBLIC HEALTH

1 LOCATION OF WELL		Fraction		Section No.		Town		Range			
County <u>Ingham</u>		Twp. <u>Delhi</u>		<u>SE 1/4 SW 13</u>		<u>3 N 1</u>		<u>2 1 W</u>			
Distance and Direction from Road Intersections				OWNER No. <u>3881</u>		3 OWNER OF WELL: Address <u>Corneal Veltama Bldr. & owner</u>					
Street address & City of Well Location <u>3081 Willoughby Rd. Lansing</u>				4 WELL DEPTH: (completed) Date of Completion <u>135'</u> ft. <u>Jan. 12, 1967</u>							
2 FORMATION		THICKNESS OF STRATUM		DEPTH TO BOTTOM OF STRATUM		5 <input type="checkbox"/> Cable tool <input checked="" type="checkbox"/> Rotary <input type="checkbox"/> Driven <input type="checkbox"/> Dug <input type="checkbox"/> Hollow rod <input type="checkbox"/> Jetted <input type="checkbox"/> Bored <input type="checkbox"/> _____					
clay				22'		6 USE: <input checked="" type="checkbox"/> Domestic <input type="checkbox"/> Public Supply <input type="checkbox"/> Industry <input type="checkbox"/> Irrigation <input type="checkbox"/> Air Conditioning <input type="checkbox"/> Commercial <input type="checkbox"/> Test Well <input type="checkbox"/> _____					
water sand				30'		7 CASING: Threaded <input checked="" type="checkbox"/> Welded <input type="checkbox"/> Diam. <u>4"</u> in. to <u>73'</u> ft. Depth Height: Above/Below surface _____ ft. Weight <u>11</u> lbs/ft. Drive Shoe? Yes <input checked="" type="checkbox"/> No <input type="checkbox"/>					
clay & gravel				50'		8 SCREEN: Type: <u>none</u> Dia.: _____ Slot/Gauze _____ Length _____ Set between _____ ft. and _____ ft. Fittings: _____					
water sand				55'							
clay				(59')							
rock				60'							
shale & soft rock				100'							
rock				135'		9 STATIC WATER LEVEL <u>30'</u> ft. below land surface					
						10 PUMPING LEVEL below land surface _____ ft. after _____ hrs. pumping <u>50</u> g.p.m. _____ ft. after _____ hrs. pumping _____ g.p.m.					
						11 WATER QUALITY In Parts Per Million: Iron (Fe) _____ Chlorides (Cl) _____ Hardness _____					
						12 WELL HEAD COMPLETION: <input type="checkbox"/> In Approved Pit <input checked="" type="checkbox"/> Pitless Adapter <input type="checkbox"/> 12" Above Grade					
						13 GROUTING: Well Grouted? <input type="checkbox"/> Yes <input checked="" type="checkbox"/> No Material: <input type="checkbox"/> Neat Cement <input type="checkbox"/> _____ Depth: From _____ ft. to _____ ft.					
						14 SANITARY: Nearest Source of possible contamination _____ feet _____ Direction _____ Type _____ Well disinfected upon completion <input type="checkbox"/> Yes <input checked="" type="checkbox"/> No					
						15 PUMP: Manufacturer's Name <u>Aermotor</u> Model Number _____ HP <u>3/4</u> Length of Drop Pipe <u>63'</u> ft. capacity _____ G.P.M. Type: <input checked="" type="checkbox"/> Submersible <input type="checkbox"/> _____ <input type="checkbox"/> Jet <input type="checkbox"/> Reciprocating					
16 Remarks, elevation, source of data, etc. ADDED INFO. BY DRILLER, ITEM NO. CORRECTED BY: ADDITION BY:				17 WATER WELL CONTRACTOR'S CERTIFICATION: This well was drilled under my jurisdiction and this report is true to the best of my knowledge and belief. DAILY & JACKSON WELL DRILLING, INC. <u>0390</u> <small>REGISTERED BUSINESS NAME REGISTRATION NO.</small> Address <u>6534 Aurelius Rd. Lansing</u> Signed <u>Velma R. Jackson</u> Date <u>Jan. 14, 1967</u> <small>AUTHORIZED REPRESENTATIVE</small>							
										Willoughby Rd.	

MAY 24 1967

1 LOCATION OF WELL			NEE NEE NW		
County	Twp.	Fraction	Section No.	Town	Range
Ingham	Delhi	13 1/4	13	T3N N/S.	R2W E/W.
Distance And Direction from Road Intersections 1/2 Mi. E of intersection of Pine-tree and E, Willoughby Rd. on S side of latter.			3 OWNER OF WELL: Neal Valetma Address: 1613 Colorado Dr. East Lansing, Michigan		
Street address & City of Well Location: Willoughby Rd., Holt, Michigan			4 WELL DEPTH: (completed) 138 ft. Date of Completion: 1/22/68		
2 FORMATION	THICKNESS OF STRATUM	DEPTH TO BOTTOM OF STRATUM	5 <input type="checkbox"/> Cable tool <input checked="" type="checkbox"/> Rotary <input type="checkbox"/> Driven <input type="checkbox"/> Dug <input type="checkbox"/> Hollow rod <input type="checkbox"/> Jetted <input type="checkbox"/> Bored <input type="checkbox"/>		
clay & gravel	20	20	6 USE: <input checked="" type="checkbox"/> Domestic <input type="checkbox"/> Public Supply <input type="checkbox"/> Industry <input type="checkbox"/> Irrigation <input type="checkbox"/> Air Conditioning <input type="checkbox"/> Commercial <input type="checkbox"/> Test Well <input type="checkbox"/>		
watersand	15	35	7 CASING: Threaded <input checked="" type="checkbox"/> Welded <input type="checkbox"/> Diam. 4 in. to 75 ft. Depth surface 1 ft. Weight lbs/ft. Drive Shoe? Yes <input checked="" type="checkbox"/> No <input type="checkbox"/>		
clay & gravel	30	65	8 SCREEN: None Type: _____ Dia.: _____ Slot/Gauze _____ Length _____ Set between _____ ft. and _____ ft. Fittings: _____		
shale & rock	15	80	9 STATIC WATER LEVEL: 25 ft. below land surface		
rock	20	100	10 PUMPING LEVEL below land surface _____ ft. after _____ hrs. pumping 25 g.p.m.		
shale & rock	38	138	11 WATER QUALITY in Parts Per Million: unknown Iron (Fe) _____ Chlorides (Cl) _____ Hardness _____		
See note below			12 WELL HEAD COMPLETION: <input type="checkbox"/> In Approved Pit <input checked="" type="checkbox"/> Pitless Adapter <input type="checkbox"/> 12" Above Grade		
			13 GROUTING: Well Grouted? <input checked="" type="checkbox"/> Yes <input type="checkbox"/> No Material: <input type="checkbox"/> Neat Cement <input type="checkbox"/> Depth: From _____ ft. to _____ ft.		
			14 SANITARY: Nearest Source of possible contamination 60 feet SW Direction septic Type Well disinfected upon completion <input checked="" type="checkbox"/> Yes <input type="checkbox"/> No		
			15 PUMP: Manufacturer's Name Wehtrol Model Number 102958SP HP 1/2 Length of Drop Pipe 54 ft. capacity 11 G.P.M. Type: <input checked="" type="checkbox"/> Submersible <input type="checkbox"/> <input type="checkbox"/> Jet <input type="checkbox"/> Reciprocating		
16 Remarks, elevation, source of data, etc. Note: Address unknown but is first house E of 3801 E. Willoughby Rd., Holt, Michigan			17 WATER WELL CONTRACTOR'S CERTIFICATION: This well was drilled under my jurisdiction and this report is true to the best of my knowledge and belief.		
ADDED INFO BY DRILLER, ITEM NO. _____ *CORRECTED BY: _____			DAILY & JACKSON WELL DRILLING, INC. 0390 <small>REGISTERED BUSINESS NAME REGISTERATION NO.</small> Address 6534 Aurelius Rd., Lansing, Michigan Signed <i>James Bowen</i> Date 5/7/68 <small>AUTHORIZED REPRESENTATIVE</small>		



S/N6879-1 DEC 14 1979
 Invoice #2275

WATER WELL RECORD
 ACT 294 PA 1965

MICHIGAN DEPARTMENT
 OF
 PUBLIC HEALTH

R2W

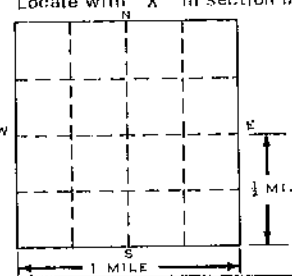
1 LOCATION OF WELL			3 OWNER OF WELL:																				
County Ingham	Township Name Alaiedon <i>Delhi</i>	Fraction <i>1/4 NE 1/4 Sec 13</i>	Section Number 13	Town Number T3N	Range Number R2W E/W.																		
Distance And Direction from Road Intersections 75 yds. East of Veltema Drive 1/2 mile south of Willoughby Rd.			Address 2396 Veltema Drive Holt, Michigan 48842																				
Street Address & City of Well Location Locate with "X" in section below			Date of Completion 6-3-79																				
Sketch Map: 			4 WELL DEPTH: (completed) 102 ft.																				
2 FORMATION			5 USE: <input checked="" type="checkbox"/> Domestic <input type="checkbox"/> Public Supply <input type="checkbox"/> Industry																				
			<input type="checkbox"/> Irrigation <input type="checkbox"/> Air Conditioning <input type="checkbox"/> Commercial																				
<table border="1" style="width: 100%; border-collapse: collapse;"> <thead> <tr> <th style="width: 30%;">FORMATION</th> <th style="width: 20%;">THICKNESS OF STRATUM</th> <th style="width: 20%;">DEPTH TO BOTTOM OF STRATUM</th> </tr> </thead> <tbody> <tr> <td>Clay</td> <td>15'</td> <td>15'</td> </tr> <tr> <td>Water Gravel</td> <td>10'</td> <td>25'</td> </tr> <tr> <td>Sand & Gravel</td> <td>35'</td> <td>60'</td> </tr> <tr> <td>Soft White Rock</td> <td>18'</td> <td>78'</td> </tr> <tr> <td>Gray Rock</td> <td>24'</td> <td>102'</td> </tr> </tbody> </table>			FORMATION	THICKNESS OF STRATUM	DEPTH TO BOTTOM OF STRATUM	Clay	15'	15'	Water Gravel	10'	25'	Sand & Gravel	35'	60'	Soft White Rock	18'	78'	Gray Rock	24'	102'	7 CASING: Threaded <input checked="" type="checkbox"/> Welded <input type="checkbox"/> Diam. 4 in. to 78 ft. Depth		
			FORMATION	THICKNESS OF STRATUM	DEPTH TO BOTTOM OF STRATUM																		
Clay	15'	15'																					
Water Gravel	10'	25'																					
Sand & Gravel	35'	60'																					
Soft White Rock	18'	78'																					
Gray Rock	24'	102'																					
			Height: Above Surface Surface 1 ft. Weight 11 lbs./ft. Drive Shoes? Yes <input checked="" type="checkbox"/> No <input type="checkbox"/>																				
			8 SCREEN: Type: NONE Dia.: _____ Slot/Gauzo _____ Length _____ Set between _____ ft. and _____ ft. Fittings: _____																				
			9 STATIC WATER LEVEL 40' ft. below land surface																				
			10 PUMPING LEVEL below land surface 40' ft. after _____ hrs. pumping 20 g.p.m. _____ ft. after _____ hrs. pumping _____ g.p.m.																				
			11 WATER QUALITY in Parts Per Million: Iron (Fe) _____ Chlorides (Cl) _____ Hardness _____ Other _____																				
			12 WELL HEAD COMPLETION: <input type="checkbox"/> In Approved Pit <input checked="" type="checkbox"/> Pitless Adapter <input type="checkbox"/> 12" Above Grade																				
			13 Well Grouted? <input checked="" type="checkbox"/> Yes <input type="checkbox"/> No <input type="checkbox"/> Neat Cement <input type="checkbox"/> Bentonite <input type="checkbox"/> _____ Depth: From _____ ft. to _____ ft.																				
			14 Nearest Source of possible contamination _____ feet _____ Direction <input checked="" type="checkbox"/> Yes <input type="checkbox"/> No Well disinfected upon completion <input checked="" type="checkbox"/> Yes <input type="checkbox"/> No																				
			15 PUMP: <input type="checkbox"/> Not installed Manufacturer's Name Aermotor 3W230VED8-50 Model Number 8D8-50 HP 1/2 Volts 230 Length of Drop Pipe 50 ft. capacity 8 G.P.M. Type: <input checked="" type="checkbox"/> Submersible Sec. 80ty PVC D.P. <input type="checkbox"/> Jet <input type="checkbox"/> Reciprocating PP-59 Medalist Tank Motor Date Code 1-77 Pump Date Code N-77																				
16 Remarks, elevation, source of data, etc. ADDED INFO BY DRILLER, ITEM NO. CORRECTED BY <i>VJ</i> ADDITION BY _____ ELEVATION _____ DEPTH TO ROCK _____			17 WATER WELL CONTRACTOR'S CERTIFICATION: This well was drilled under my jurisdiction and this report is true to the best of my knowledge and belief. Daily's Well Drilling, Inc. 0390 REGISTERED BUSINESS NAME REGISTRATION NO. Address 6534 Aurelius Rd., Lansing, Mi. 48910 Signed <i>For Ira Daily</i> Date 7-5-79 AUTHORIZED REPRESENTATIVE																				

USE A 2ND SHEET IF NEEDED

SEP 11 1973

WATER WELL RECORD
ACT 294 PA 1965

MICHIGAN DEPARTMENT
OF
PUBLIC HEALTH

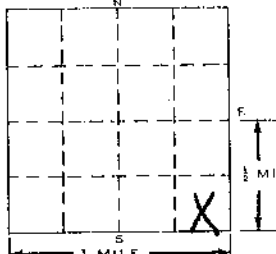
1 LOCATION OF WELL															
County <u>Ingham</u>		Township Name <u>Delhi</u>		Fraction <u>SE 1/4 SE 1/4 SE 1/4</u>		Section Number <u>13</u>		Town Number <u>3</u> (NS)		Range Number <u>2</u> (E)					
Distance and Direction from Road Intersections Let 13 College Rd Manor				Street address & City of Well Location 2049 College Rd. Holt Michigan				3 OWNER OF WELL: Address Willis Reekwood 651 Aurelius Rd. Mason Michigan				4 WELL DEPTH: (completed) <u>125</u> ft. Date of Completion <u>8-29-73</u>			
Locate with "X" in section below 				Sketch Map:				5 <input type="checkbox"/> Cable tool <input checked="" type="checkbox"/> Rotary <input type="checkbox"/> Driven <input type="checkbox"/> Dug <input type="checkbox"/> Hollow rod <input type="checkbox"/> Jetted <input type="checkbox"/> Bored <input type="checkbox"/>				6 USE: <input checked="" type="checkbox"/> Domestic <input type="checkbox"/> Public Supply <input type="checkbox"/> Industry <input type="checkbox"/> Irrigation <input type="checkbox"/> Air Conditioning <input type="checkbox"/> Commercial <input type="checkbox"/> Test Well <input type="checkbox"/>			
2 FORMATION		THICKNESS OF STRATUM		DEPTH TO BOTTOM OF STRATUM		7 CASING: Threaded <input type="checkbox"/> Welded <input checked="" type="checkbox"/> Diam. <u>4</u> in. to <u>47</u> ft. Depth		Height: Above Surface <u>1</u> ft.		Weight <u>11</u> lbs./ft.		Drive Shoe? Yes <input checked="" type="checkbox"/> No <input type="checkbox"/>			
		<u>Sand & Clay</u>		<u>32</u>		<u>32</u>		<u>4</u> in. to <u>47</u> ft. Depth							
<u>Sandrock</u>		<u>93</u>		<u>125</u>		8 SCREEN: Type: <u>None</u> Dia.: _____ Slot/Gauze _____ Length _____ Set between _____ ft. and _____ ft. Fittings: _____				9 STATIC WATER LEVEL <u>12</u> ft. below land surface					
						10 PUMPING LEVEL below land surface _____ ft. after _____ hrs. pumping _____ g.p.m. Not Required _____ ft. after _____ hrs. pumping _____ g.p.m.				11 WATER QUALITY in Parts Per Million: Iron (Fe) _____ Chlorides (Cl) _____ Not Required Hardness _____ Other _____					
						12 WELL HEAD COMPLETION: <input type="checkbox"/> In Approved Pit <input checked="" type="checkbox"/> Pitless Adapter <input type="checkbox"/> 12" Above Grade				13 Well Grouted? <input checked="" type="checkbox"/> Yes <input type="checkbox"/> No <input type="checkbox"/> Neat Cement <input checked="" type="checkbox"/> Bentonite <input type="checkbox"/> Depth: From <u>0</u> ft. to <u>47</u> ft.					
						14 Nearest Source of possible contamination <u>60</u> feet <u>E</u> Direction <u>Septic</u> Type Well disinfected upon completion <input checked="" type="checkbox"/> Yes <input type="checkbox"/> No				15 PUMP: <input type="checkbox"/> Not Installed Manufacturer's Name <u>Webtrol</u> Model Number <u>102858</u> HP <u>1/4</u> Volts <u>230</u> Length of Drop Pipe <u>42</u> ft. capacity <u>880</u> G.P.H. Type: <input checked="" type="checkbox"/> Submersible <input type="checkbox"/> Jet <input type="checkbox"/> Reciprocating					
16 Remarks, elevation, source of data, etc. <u>E1 865' ± 10'</u> <u>BR -32'</u>						17 WATER WELL CONTRACTOR'S CERTIFICATION: This well was drilled under my jurisdiction and this report is true to the best of my knowledge and belief. Maurer & Parks Inc. <u>0383</u> REGISTERED BUSINESS NAME REGISTRATION NO. Address <u>4700 N. East St. Lansing, Mich.</u> Signed <u>Eugene Maurer</u> date <u>8-31-73</u> AUTHORIZED REPRESENTATIVE									

1 LOCATION OF WELL			Fraction	Section No.	Town	Range
County	Twp.					
Ingham	Delhi		NW 1/4 NW 1/4 NE 1/4	13	T3 N 1/2	R2 1/2 W.
Distance And Direction from Road Intersections 1/2 Mi W of intersection of College & Willoughby Rds on S side of latter			3 OWNER OF WELL: Corneal Veltama Address: 3801 E. Willoughby Rd. Holt, Michigan			
Street address & City of Well Location 379 1/2 Willoughby Rd., Holt			4 WELL DEPTH: (completed) 130 ft. Date of Completion 1/20/69			
2 FORMATION	THICKNESS OF STRATUM	DEPTH TO BOTTOM OF STRATUM	5 <input checked="" type="checkbox"/> Cable tool <input type="checkbox"/> Rotary <input type="checkbox"/> Driven <input type="checkbox"/> Dug <input type="checkbox"/> Hollow rod <input type="checkbox"/> Jetted <input type="checkbox"/> Bored <input type="checkbox"/>			
sand & clay	68	68	6 USE: <input checked="" type="checkbox"/> Domestic <input type="checkbox"/> Public Supply <input type="checkbox"/> Industry <input type="checkbox"/> Irrigation <input type="checkbox"/> Air Conditioning <input type="checkbox"/> Commercial <input type="checkbox"/> Test Well <input type="checkbox"/>			
clay	6	74	7 CASING: Threading <input checked="" type="checkbox"/> Welded <input type="checkbox"/> Height: Above W.M. surface 1 ft. Diam. 4 in. to 80 ft. Depth Weight _____ lbs./ft. _____ in. to _____ ft. Depth Drive Shoe? Yes <input checked="" type="checkbox"/> No <input type="checkbox"/>			
sandrock	56	130	8 SCREEN: None Type: _____ Dia.: _____ Slot/Gauze: _____ Length: _____ Set between _____ ft. and _____ ft. Fittings: _____			
			9 STATIC WATER LEVEL _____ 50 ft. below land surface			
			10 PUMPING LEVEL below land surface _____ ft. after _____ hrs. pumping _____ 25 g.p.m. _____ ft. after _____ hrs. pumping _____ g.p.m.			
			11 WATER QUALITY in Parts Per Million: unknown Iron (Fe) _____ Chlorides (Cl) _____ Hardness _____			
			12 WELL HEAD COMPLETION: <input type="checkbox"/> In Approved Pit <input checked="" type="checkbox"/> Pitless Adapter <input type="checkbox"/> 12" Above Grade			
			13 GROUTING: Well Grouted? <input checked="" type="checkbox"/> Yes <input type="checkbox"/> No Material: <input type="checkbox"/> Neat Cement <input type="checkbox"/> Depth: From _____ ft. to _____ ft.			
			14 SANITARY: Nearest Source of possible contamination 65 feet N Direction septic Type Well disinfected upon completion <input checked="" type="checkbox"/> Yes <input type="checkbox"/> No			
			15 PUMP: Manufacturer's Name Wehtrol Model Number 102858SP HP 1/2 Length of Drop Pipe 63 ft. capacity 13 G.P.M. Type: <input checked="" type="checkbox"/> Submersible <input type="checkbox"/> <input type="checkbox"/> Jet <input type="checkbox"/> Reciprocating			
16 Remarks, elevation, source of data, etc. ADDED INFO. BY DRILLER. ITEM NO. *CORRECTED BY: <i>[Signature]</i> **ADDITION BY: <i>[Signature]</i>			17 WATER WELL CONTRACTOR'S CERTIFICATION: This well was drilled under my jurisdiction and this report is true to the best of my knowledge and belief. DAILY & JACKSON WELL DRILLING, INC. REGISTRATION NO. 0390 Address 65 1/2 Aurelius Rd., Lansing, Michigan Signed <i>[Signature]</i> Date 1/24/69 AUTHORIZED REPRESENTATIVE			



WATER WELL RECORD

ACT 294 PA 1965

MICHIGAN DEPARTMENT
OF
PUBLIC HEALTH

SE SWSW

1 LOCATION OF WELL		3 OWNER OF WELL:																
County Ingham	Township Name Delhi	Fraction SE SWSW	Section Number 13															
Distance And Direction from Road Intersections About 500' west of Wigman Rd. and About 200' North of Holt Rd.		Town Number T3 N/W																
Street address & City of Well Location 3928 E. Holt Rd., Holt		Range Number R2 E/W.																
Locate with "X" in section below 		Date of Completion September 25, 1969																
2 FORMATION <table border="1" style="width: 100%; border-collapse: collapse;"> <thead> <tr> <th style="width: 60%;">FORMATION</th> <th style="width: 20%;">THICKNESS OF STRATUM</th> <th style="width: 20%;">DEPTH TO BOTTOM OF STRATUM</th> </tr> </thead> <tbody> <tr> <td>SAND</td> <td style="text-align: center;">0'</td> <td style="text-align: center;">20'</td> </tr> <tr> <td>Hard Pan</td> <td style="text-align: center;">25'</td> <td style="text-align: center;">45'</td> </tr> <tr> <td>Coarse Gravel</td> <td style="text-align: center;">5'</td> <td style="text-align: center;">50'</td> </tr> <tr> <td>Sand Stone</td> <td style="text-align: center;">75'</td> <td style="text-align: center;">125'</td> </tr> </tbody> </table>		FORMATION	THICKNESS OF STRATUM	DEPTH TO BOTTOM OF STRATUM	SAND	0'	20'	Hard Pan	25'	45'	Coarse Gravel	5'	50'	Sand Stone	75'	125'	4 WELL DEPTH: (completed) 125' ft.	
		FORMATION	THICKNESS OF STRATUM	DEPTH TO BOTTOM OF STRATUM														
		SAND	0'	20'														
		Hard Pan	25'	45'														
Coarse Gravel	5'	50'																
Sand Stone	75'	125'																
		5 <input type="checkbox"/> Cable tool <input checked="" type="checkbox"/> Rotary <input type="checkbox"/> Driven <input type="checkbox"/> Dug <input type="checkbox"/> Hollow rod <input type="checkbox"/> Jetted <input type="checkbox"/> Bored																
		6 USE: <input checked="" type="checkbox"/> Domestic <input type="checkbox"/> Public Supply <input type="checkbox"/> Industry <input type="checkbox"/> Irrigation <input type="checkbox"/> Air Conditioning <input type="checkbox"/> Commercial <input type="checkbox"/> Test Well																
		7 CASING: Threaded <input checked="" type="checkbox"/> Welded <input type="checkbox"/> Height: Above/Below Surface 1 ft. Weight 11 lbs./ft. Drive Shoe? Yes <input checked="" type="checkbox"/> No <input type="checkbox"/>																
		8 SCREEN: Type: NONE Dia.: _____ Slot/Gauze _____ Length _____ Set between _____ ft. and _____ ft. Fittings: _____																
		9 STATIC WATER LEVEL 10 ft. below land surface																
		10 PUMPING LEVEL below land surface _____ ft. after _____ hrs. pumping 20 g.p.m. _____ ft. after _____ hrs. pumping _____ g.p.m.																
		11 WATER QUALITY in Parts Per Million: Iron (Fe) _____ Chlorides (Cl) UNKNOWN Hardness _____ Other _____																
		12 WELL HEAD COMPLETION: <input type="checkbox"/> In Approved Pit <input checked="" type="checkbox"/> Pitless Adapter <input type="checkbox"/> 12" Above Grade																
		13 Well Grouted? <input checked="" type="checkbox"/> Yes <input type="checkbox"/> No <input type="checkbox"/> Neat Cement <input type="checkbox"/> Bentonite <input type="checkbox"/> _____ Depth: From _____ ft. to _____ ft.																
		14 Nearest Source of possible contamination _____ feet _____ Direction _____ Type _____ Well disinfected upon completion <input checked="" type="checkbox"/> Yes <input type="checkbox"/> No																
		15 PUMP: <input type="checkbox"/> Not installed Manufacturer's Name Aermotor Pump Co. Model Number _____ HP 1/2 Volts 115 Length of Drop Pipe 42 ft. capacity _____ G.P.M. Type: <input checked="" type="checkbox"/> Submersible <input type="checkbox"/> Jet <input type="checkbox"/> Reciprocating																
16 Remarks, elevation, source of data, etc. ADDED INFO. BY DRILLER, FIRM NO. CORRECTED BY: ADDITIONAL BY:		17 WATER WELL CONTRACTOR'S CERTIFICATION: This well was drilled under my jurisdiction and this report is true to the best of my knowledge and belief. Daily & Jackson Well Drilling, Inc. 0390 <small>REGISTERED BUSINESS NAME REGISTRATION NO.</small> Address 6534 Aurelius Rd., Lansing, Michigan Signed <i>Velma R. Jackson</i> Date Oct. 6, 1969 <small>AUTHORIZED REPRESENTATIVE</small>																



#1122

WATER WELL RECORD
ACT 294 PA 1965

MICHIGAN DEPARTMENT
OF
PUBLIC HEALTH

NINNE NW

1 LOCATION OF WELL		3 OWNER OF WELL:	
County INGHAM	Township Name Delhi	Fraction NW 1/4 NINNE NW	Section Number 13
Distance And Direction from Road Intersections Well is located about 180' South of the intersection of Pinetree Rd. and Willoughby and about 1/4 of a mile East of intersection of Willoughby Rd., Holt		Town Number T3 N/2	
Street address & City of Well Location Willoughby Rd., Holt		Range Number R2 E/W.	

Locate with "X" in section below
Sketch Map:

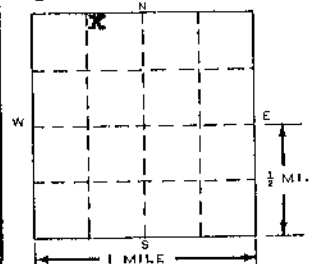

Address
**Neal Veltma
Willoughby Rd.
Holt, Michigan**

4 WELL DEPTH: (completed) Date of Completion
125 ft. Feb. 24, 1970

5 Cable tool Rotary Driven Dug
 Hollow rod Jetted Borod

6 USE: Domestic Public Supply Industry
 Irrigation Air Conditioning Commercial
 Test Well

7 CASING: Threaded Welded
Diam. **4 in.** to **76 ft.** Depth
Height: Above/Below Surface **1** ft.
Weight **11** lbs./ft.
Drive Shoe? Yes No

2 FORMATION

FORMATION	THICKNESS OF STRATUM	DEPTH TO BOTTOM OF STRATUM
Mud	0'	11'
Sand and gravel	54'	65'
Sandrock	60'	125'

8 SCREEN:
Type: **None** Dia.: _____
Slot/Gauze _____ Length _____
Set between _____ ft. and _____ ft.
Fittings: _____

9 STATIC WATER LEVEL
40 ft. below land surface

10 PUMPING LEVEL below land surface
_____ ft. after _____ hrs. pumping **30** g.p.m.
_____ ft. after _____ hrs. pumping _____ g.p.m.

11 WATER QUALITY in Parts Per Million:
Iron (Fe) _____ Chlorides (Cl) **UNKNOWN**
Hardness _____ Other _____

12 WELL HEAD COMPLETION: In Approved Pit
 Pitless Adapter 12" Above Grade

13 Well Grouted? Yes No
 Neat Cement Bentonite
Depth: From _____ ft. to _____ ft.

14 Nearest Source of possible contamination
70 feet **N** Direction **Septic** Type
Well disinfected upon completion Yes No

15 PUMP: Not installed
Manufacturer's Name _____
Model Number _____ HP _____ Volts _____
Length of Drop Pipe _____ ft. capacity _____ G.P.M.
Type: Submersible Jet Reciprocating

16 Remarks, elevation, source of data, etc.

ADDED INFO. BY JRL:K. ITEM NO _____

CORRECTED BY: _____

**ADDITION BY: _____

17 WATER WELL CONTRACTOR'S CERTIFICATION:
This well was drilled under my jurisdiction and this report is true to the best of my knowledge and belief.
Daily & Jackson Well Drilling, Inc. 0390
REGISTERED BUSINESS NAME REGISTRATION NO.
Address **6534 Aurelius Rd., Lansing, Michigan**
Signed *Helma R. Jackson* Date **5/22/70**
AUTHORIZED REPRESENTATIVE

Inv# 2143

S/N 3R78-10

JUN 07 1978

WATER WELL RECORD
ACT 294 PA 1965

MICHIGAN DEPARTMENT OF PUBLIC HEALTH

1 LOCATION OF WELL
 County: Ingham Township Name: Delhi Fraction: 1/4 NE 1/4 NW 1/4 Section Number: 13 Town Number: T3N N/S. Range Number: R2W E/W.

Distance And Direction from Road Intersections: Willoughby Heights

Street address & City of Well Location: 3805 Willoughby Rd. Holt, MI 48842

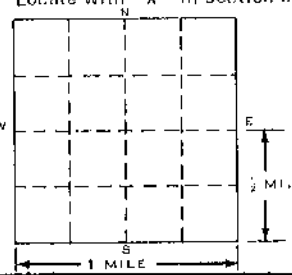
Locate with "X" in section below Sketch Map: 

3 OWNER OF WELL:
 Address: Corneal Veltma 3805 Willoughby Rd. Holt, MI 48842

4 WELL DEPTH: (completed) Date of Completion: 110' ft.

5 Cable tool Rotary Driven Dug
 Hollow rod Jetted Bored

6 USE: Domestic Public Supply Industry
 Irrigation Air Conditioning Commercial
 Test Well

7 CASING: Threaded Welded Height: Above/Below Surface: 1 ft. Weight: 11 lbs./ft. Drive Shoe? Yes No

4 in. to 71 ft. Depth

8 SCREEN:
 Type: _____ Dia.: _____
 Slot/Gauze _____ Length _____
 Set between _____ ft. and _____ ft.
 Fittings: _____

9 STATIC WATER LEVEL 25 ft. below land surface

10 PUMPING LEVEL below land surface
 _____ ft. after _____ hrs. pumping _____ g.p.m.
 _____ ft. after _____ hrs. pumping 30 g.p.m.

11 WATER QUALITY in Parts Per Million:
 Iron (Fe) _____ Chlorides (Cl) _____
 Hardness _____ Other _____

12 WELL HEAD COMPLETION: In Approved Pit
 Pitless Adaptor 12" Above Grade

13 Well Grouted? Yes No
 Neat Cement Bentonite
 Depth: From _____ ft. to _____ ft.

14 Nearest Source of possible contamination
 _____ feet _____ Direction _____ Type _____
 Well disinfected upon completion Yes No

15 PUMP: Not installed
 Manufacturer's Name: Aermotor
 Model Number: SD12-50 HP: 1/2 Volts: 230
 Length of Drop Pipe: 40 ft. capacity: 30 G.P.M.
 Type: Submersible Jet Reciprocating

16 Remarks, elevation, source of data, etc.
 ADDED INFO BY DRILLER, ITEM NO.
 *CORRECTED BY VJ
 **ADDITION BY _____
 ELEVATION _____
 DEPTH TO ROCK _____

17 WATER WELL CONTRACTOR'S CERTIFICATION:
 This well was drilled under my jurisdiction and this report is true to the best of my knowledge and belief.
Daily & Jackson Well Drilling, Inc. 0390
 REGISTERED BUSINESS NAME REGISTRATION NO.
 Address: 6534 Aurlieus Rd., Lansing, MI
 Signed: [Signature] Date: 4/28/78
 AUTHORIZED REPRESENTATIVE

AUG 5 1983

WATER WELL AND PUMP RECORD

PART 127 ACT 368, P.A. 1978

PERMIT NUMBER

1 LOCATION OF WELL		Fraction		Section Number		Town Number		Range Number	
County Ingham		Township Name Delhi		1/4 1/4 1/4		13		T3N N/S R2W E/W	
Distance and Direction From Road Intersection 65' north of Holt Rd. 5/10ths mile west of College Rd.					3 OWNER OF WELL: Frank Smalley Address 3804 W. Holt Rd. Holt, Michigan 48842 Address Same As Well Location? <input checked="" type="checkbox"/> Yes <input type="checkbox"/> No				
Street Address & City of Well Location Locate with "X" in Section Below					4 WELL DEPTH: (completed) 115' ft. Date of Completion 2/17/83				
Sketch Map: 					5 <input type="checkbox"/> Cable tool <input checked="" type="checkbox"/> Rotary <input type="checkbox"/> Driven <input type="checkbox"/> Dug <input type="checkbox"/> Hollow rod <input type="checkbox"/> Auger <input type="checkbox"/> Jetted				
					6 USE: <input checked="" type="checkbox"/> Domestic <input type="checkbox"/> Type I Public <input type="checkbox"/> Type III Public <input type="checkbox"/> Irrigation <input type="checkbox"/> Type IIa Public <input type="checkbox"/> Hoat pump <input type="checkbox"/> Test Well <input type="checkbox"/> Type IIb Public				
					7 CASING: <input type="checkbox"/> Steel <input type="checkbox"/> Threaded <input type="checkbox"/> Height: Above/Below Surface 16" X <input checked="" type="checkbox"/> PVC <input checked="" type="checkbox"/> Plastic <input type="checkbox"/> Welded 2.87 lbs./ft. 5 in. to 68'10" depth in. to _____ ft. depth 7 7/8" Grouped Drill Hole Diameter in. to 67'6" ft. depth in. to _____ ft. depth Drive Shoe <input checked="" type="checkbox"/> Yes <input type="checkbox"/> No				
2 FORMATION DESCRIPTION		THICKNESS OF STRATUM		DEPTH TO BOTTOM OF STRATUM					
Sandy Clay		8		8					
Gray Clay		22		30		8 SCREEN: <input checked="" type="checkbox"/> Not Installed Type _____ Diameter _____ Slot/Gauge _____ Length _____ Set between _____ ft. and _____ ft. FITTINGS: <input type="checkbox"/> K-Packer <input type="checkbox"/> Lead Packer <input type="checkbox"/> Bremer Check <input type="checkbox"/> Blank above screen _____ ft. Other _____			
Gravel w/clay strips		20		50					
Soft Sandstone & Shale		16		66		9 STATIC WATER LEVEL: 33' ft. below land surface <input type="checkbox"/> Flow			
Sandstone w/crevices		17		83		10 PUMPING LEVEL: below land surface 60 ft. after _____ hrs. pumping at 30 G.P.M. _____ ft. after _____ hrs. pumping at _____ G.P.M.			
Black Shale w/sandstone strips		7		90		11 WELL HEAD COMPLETION: <input checked="" type="checkbox"/> Loss adapter <input checked="" type="checkbox"/> 12" above grade <input type="checkbox"/> Basement offset <input type="checkbox"/> Approved pit			
Sandstone w/lime strips		25		115		12 WELL GROUTED? <input type="checkbox"/> No <input checked="" type="checkbox"/> Yes From _____ to _____ ft. <input type="checkbox"/> Neat cement <input checked="" type="checkbox"/> Bentonite <input type="checkbox"/> Other _____ No. of bags of cement _____ Additives _____			
					13 Nearest source of possible contamination Type _____ Distance _____ ft. Direction _____ Well disinfected upon completion? <input checked="" type="checkbox"/> Yes <input type="checkbox"/> No				
					14 PUMP: <input type="checkbox"/> Not installed <input type="checkbox"/> Pump Installation Only Manufacturer's name McDonald Model number 18050K2 HP 1/2 Volts 230 Length of Drop Pipe 60 ft. capacity _____ G.P.M. TYPE: <input checked="" type="checkbox"/> Submersible <input type="checkbox"/> Jet PRESSURE TANK: Manufacturer's name WX202 Well-X-Trol Model number _____ Capacity _____ Gallons				
15. Remarks, elevation, source of data, etc. ADDDED INFO BY DRILLER, ITAM DIA. *CORRECTED BY **ADDITION BY ELEVATION DEPTH TO ROCK					16. WATER WELL CONTRACTOR'S CERTIFICATION: This well was drilled under my jurisdiction and this report is true to the best of my knowledge and belief Hart Well Drilling Co. 522 REGISTERED BUSINESS NAME REGISTRATION NO. Address 1154 S. Jefferson Nason, Michigan 48854 Signed <i>[Signature]</i> Date 2/18/83 AUTHORIZED REPRESENTATIVE				

RECEIVED
 Mich. Dept. of Public Health
 JUN 30 1983
 Environmental and
 Geographical Health
 Services Administration



APR 01 1980

WATER WELL RECORD
ACT 294 PA 1965

MICHIGAN DEPARTMENT
OF
PUBLIC HEALTH

1 LOCATION OF WELL		County Ingham	Township Name Delhi	Fraction sw 1/4 ne 1/4 nw 1/4	Section Number 13	Town Number T3 N4	Range Number R2 E/W.
Distance And Direction from Road Intersections 1000' S. of Willoughby on Busch Circle				3 OWNER OF WELL: Corneal Veltema			
Street address & City of Well Location 3807 Busch Circle Holt, Mi. 48842				Address 3805 Willoughby Holt, Mi. 48842			
Locate with "X" in section below		Sketch Map:					
		<div style="display: flex; align-items: center; justify-content: center;"> <div style="writing-mode: vertical-rl; transform: rotate(180deg); border-left: 1px solid black; padding-left: 5px; margin-right: 10px;">WILLOUGHBY</div> <div style="border-bottom: 1px solid black; padding-bottom: 5px; margin-left: 10px;">BUSCH</div> </div>					
2 FORMATION		THICKNESS OF STRATUM	DEPTH TO BOTTOM OF STRATUM		4 WELL DEPTH: (completed) Date of Completion		
Brown clay		10	10		100 ft. April 23, 1980		
Blue clay		20	30		5 <input type="checkbox"/> Cable tool <input checked="" type="checkbox"/> Rotary <input type="checkbox"/> Driven <input type="checkbox"/> Dug		
Sand & gravel		30	60		<input type="checkbox"/> Hollow rod <input type="checkbox"/> Jetted <input type="checkbox"/> Bored <input type="checkbox"/>		
Clay & gravel		15	75		6 USE: <input checked="" type="checkbox"/> Domestic <input type="checkbox"/> Public Supply <input type="checkbox"/> Industry		
Sand rock		25	100		<input type="checkbox"/> Irrigation <input type="checkbox"/> Air Conditioning <input type="checkbox"/> Commercial		
					<input type="checkbox"/> Test Well		
					7 CASING: Threaded <input checked="" type="checkbox"/> Welded <input type="checkbox"/>		
					Height: Above/Below Surface 1 ft.		
					Weight 11 lbs./ft.		
					Drive Shoe? Yes <input checked="" type="checkbox"/> No <input type="checkbox"/>		
					8 SCREEN: Rock		
					Type: _____ Dia.: _____		
					Slot/Gauze _____ Length _____		
					Set between _____ ft. and _____ ft.		
					Fittings: _____		
					9 STATIC WATER LEVEL		
					15 ft. below land surface		
					10 PUMPING LEVEL below land surface		
					40 ft. after 2 hrs. pumping 20 g.p.m.		
					_____ ft. after _____ hrs. pumping _____ g.p.m.		
					11 WATER QUALITY in Parts Per Million:		
					Iron (Fe) _____ Chlorides (Cl) _____		
					None taken		
					Hardness _____ Other _____		
					12 WELL HEAD COMPLETION: <input type="checkbox"/> In Approved Pit		
					<input checked="" type="checkbox"/> Pitless Adapter <input type="checkbox"/> 12" Above Grade		
					13 Well Grouted? <input type="checkbox"/> Yes <input checked="" type="checkbox"/> No		
					<input type="checkbox"/> Neat Cement <input type="checkbox"/> Bentonite <input type="checkbox"/>		
					Depth: From _____ ft. to _____ ft.		
					14 Nearest Source of possible contamination		
					50 feet N. Direction sewer Type		
					Well disinfected upon completion <input checked="" type="checkbox"/> Yes <input type="checkbox"/> No		
					15 PUMP: <input type="checkbox"/> Not installed		
					Manufacturer's Name F. A. W.		
					Model Number 303 HP 1/2 Volts 220		
					Length of Drop Pipe 40 ft. capacity 10 G.P.M.		
					Type: <input checked="" type="checkbox"/> Submersible		
					<input type="checkbox"/> Jet <input type="checkbox"/> Reciprocating		

USE A 2ND SHEET IF NEEDED

16 Remarks, elevation, source of data, etc.

ADDED INFO BY DRILLER, ITEM NO.

*CORRECTED BY

**ADDITION BY

ELEVATION

DEPTH TO ROCK

17 WATER WELL CONTRACTOR'S CERTIFICATION:

This well was drilled under my jurisdiction and this report is true to the best of my knowledge and belief.

Mary's Well Drilling **1176**

REGISTERED BUSINESS NAME REGISTRATION NO.

Address **4340 Holt Rd. Holt, Mi. 48842**

Signed *Marcus M. Mullins* Date **March 20, 1980**

AUTHORIZED REPRESENTATIVE

APR 01 1980

WATER WELL RECORD
ACT 294 PA 1965

MICHIGAN DEPARTMENT
OF
PUBLIC HEALTH

1 LOCATION OF WELL

County Ingham	Township Name Delhi	Fraction sw 1/4 ne 1/4 sec 13	Section Number 13	Town Number 73	Range Number R2
-------------------------	-------------------------------	---	-----------------------------	--------------------------	---------------------------

Distance And Direction from Road Intersections
3808 S. of Busch Circle Holt, Mi. 48842
1000' S. of Willoughby on Busch Circle

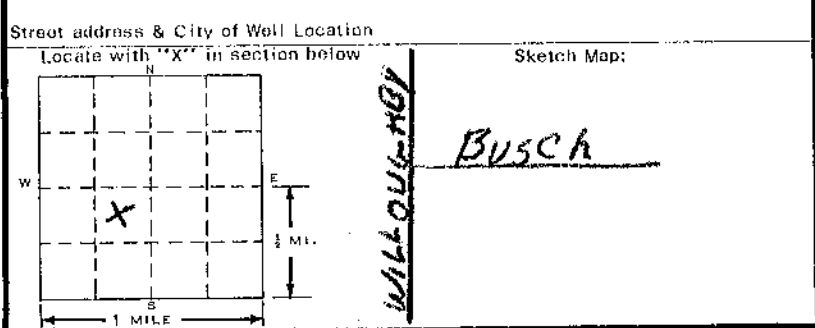

3 OWNER OF WELL:
Corneal Veltema
Address **3805 Willoughby Holt, Mi. 48842**

4 WELL DEPTH: (completed) **100** ft. Date of Completion **April 24, 1979**

5 Cable tool Rotary Driven Dug
 Hollow rod Jotted Bored

6 USE Domestic Public Supply Industry
 Irrigation Air Conditioning Commercial
 Test Well

7 CASING: Threaded Welded
Diam. **4** in. to **75** ft. Depth
Height: Above/Below Surface **1** ft.
Weight **11** lbs./ft.
Drive Shoe? Yes No

2 FORMATION

FORMATION	THICKNESS OF STRATUM	DEPTH TO BOTTOM OF STRATUM
Brown clay	5	5
Blue clay	20	25
Sand & gravel	30	55
Clay & gravel	20	75
Sand rock	25	100

8 SCREEN:
Type: **Rock** Dia.: _____
Slot/Gauze _____ Length _____
Set between _____ ft. and _____ ft.
Fittings: _____

9 STATIC WATER LEVEL
15 ft. below land surface

10 PUMPING LEVEL below land surface
40 ft. after **8** hrs. pumping **20** g.p.m.
_____ ft. after _____ hrs. pumping _____ g.p.m.

11 WATER QUALITY in Parts Per Million:
Iron (Fe) _____ Chlorides (Cl) _____
None taken
Hardness _____ Other _____

12 WELL HEAD COMPLETION: In Approved Pit
 Pitless Adaptor 12" Above Grade

13 Well Grouted? Yes No
 Neat Cement Bentonite _____
Depth: From _____ ft. to _____ ft.

14 Nearest Source of possible contamination
40 feet **S** Direction **sewer** Type _____
Well disinfected upon completion Yes No

15 PUMP: Not installed
Manufacturer's Name **F. & W.**
Model Number **303** HP **1/2** Volts **220**
Length of Drop Pipe **40** ft. capacity **10** G.P.M.
Type: Submersible Jet Reciprocating

16 Remarks, elevation, source of data, etc.

ADDED INFO BY DRILLER, ITEM NO.
*CORRECTED BY
**ADDITION BY
ELEVATION
DEPTH TO ROCK

17 WATER WELL CONTRACTOR'S CERTIFICATION:
This well was drilled under my jurisdiction and this report is true to the best of my knowledge and belief.
Merv's Well Drilling **1176**
REGISTERED BUSINESS NAME REGISTRATION NO.
Address **4340 Holt Rd. Holt, Mi. 48842**
Signed *Merv's Well Drilling* Date **3/20/79**
AUTHORIZED REPRESENTATIVE



APR 29 1980

WATER WELL RECORD
ACT 294 PA 1966

MICHIGAN DEPARTMENT
OF
PUBLIC HEALTH

1 LOCATION OF WELL											
County Ingham	Township Name Delhi	Fraction 50 1/2 SE 1/4	Section Number 13	Town Number 3 N.E.	Range Number 2 W.						
Distance And Direction from Road Intersections						3 OWNER OF WELLS Address Russ Bykerk (CORNELIUS) 3818 Keller Rd. Holt, Michigan 48842					
Street address & City of Well Location 3818 Keller Rd Holt, MI.						4 WELL DEPTH: (completed) Date of Completion 125 ft. 3-20-80					
Locate with "X" in section below Sketch Map: Keller Rd						5 <input type="checkbox"/> Cable tool <input type="checkbox"/> Rotary <input type="checkbox"/> Driven <input type="checkbox"/> Dug <input checked="" type="checkbox"/> Hollow rod <input type="checkbox"/> Jetted <input type="checkbox"/> Bored <input type="checkbox"/>					
						6 USE: <input checked="" type="checkbox"/> Domestic <input type="checkbox"/> Public Supply <input type="checkbox"/> Industry <input type="checkbox"/> Irrigation <input type="checkbox"/> Air Conditioning <input type="checkbox"/> Commercial <input type="checkbox"/> Test Well <input type="checkbox"/>					
						7 CASING: Threaded <input checked="" type="checkbox"/> Welded <input type="checkbox"/> Diam. 2 in. to 7 1/2 ft. Depth Height: Above 0 Surface 1 ft. Weight 3.25 lbs./ft. Drive Shoe? Yes <input checked="" type="checkbox"/> No <input type="checkbox"/>					
2 FORMATION		THICKNESS OF STRATUM	DEPTH TO BOTTOM OF STRATUM	8 SCREEN: Type: NONE Dia.: _____ Slot/Gauze _____ Length _____ Set between _____ ft. and _____ ft. Fittings: _____							
Clay - sand		10	10	9 STATIC WATER LEVEL 42 ft. below land surface							
SAND		49	59	10 PUMPING LEVEL below land surface 42 ft. after 1 hrs. pumping 10 g.p.m.							
SAND GRAVEL		4	63	_____ ft. after _____ hrs. pumping _____ g.p.m.							
Runny Rock		10	73	11 WATER QUALITY in Parts Per Million: Iron (Fe) _____ Chlorides (Cl) _____ Hardness _____ Other clear							
White Rock		28	101	12 WELL HEAD COMPLETION: <input type="checkbox"/> In Approved Pit <input checked="" type="checkbox"/> Pitless Adapter <input type="checkbox"/> 12" Above Grade							
White Shale		2	103	13 Well Grouted? <input type="checkbox"/> Yes <input checked="" type="checkbox"/> No <input type="checkbox"/> Neat Cement <input type="checkbox"/> Bentonite <input type="checkbox"/> _____ Depth: From _____ ft. to _____ ft.							
White Rock		22	125	14 Nearest Source of possible contamination 55 feet SE Direction SEPTIC TANK Type _____ Well disinfected upon completion <input type="checkbox"/> Yes <input type="checkbox"/> No							
				15 PUMP: <input checked="" type="checkbox"/> Not installed Manufacturer's Name _____ Model Number _____ HP _____ Volts _____ Length of Drop Pipe 60 ft. capacity _____ G.P.M. Type: <input type="checkbox"/> Submersible <input type="checkbox"/> Jet <input type="checkbox"/> Reciprocating							
USE A 2ND SHEET IF NEEDED											
16 Remarks, elevation, source of data, etc. *CORRECTED BY _____ *ADDITION BY _____ ELEVATION _____ DEPTH TO ROCK _____				17 WATER WELL CONTRACTOR'S CERTIFICATION: This well was drilled under my jurisdiction and this report is true to the best of my knowledge and belief. Rhode Well DRILLING 33-0230 REGISTERED BUSINESS NAME REGISTRATION NO. Address 961 DART Rd. MASON, MI. 48854 Signed Rhodes Date 3-24-80 AUTHORIZED REPRESENTATIVE							



WATER WELL RECORD

ACT 294 PA 1965

MICHIGAN DEPARTMENT
OF
PUBLIC HEALTH

MAR 09 1971

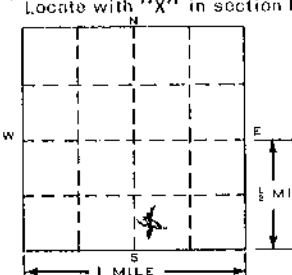
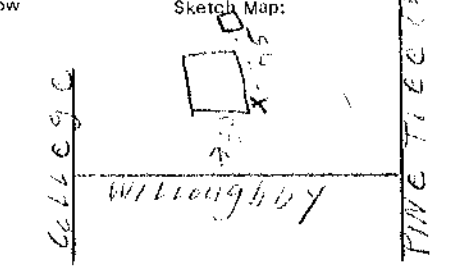
1 LOCATION OF WELL		
County INGHAM	Township Name Delhi	Fraction NW 1/4 NW 1/4 NE 1/4
Distance And Direction from Road Intersections 1/2 mi. E. of Pine Tree, 1/2 mi. W. of Willoughby on S. side of Willoughby		Section Number 13
Street address & City of Well Location 3751 Willoughby Holt Mich.		Town Number T3 N/X
Locate with "X" in section below 		Range Number R2 X/W.
Sketch Map: 		3 OWNER OF WELL: RON FLINN
		Address 3751 Willoughby Holt, Mich.
		4 WELL DEPTH: (completed) Date of Completion 120 ft. 6-30-70
		5 <input checked="" type="checkbox"/> Cable tool <input type="checkbox"/> Rotary <input type="checkbox"/> Driven <input type="checkbox"/> Dug <input type="checkbox"/> Hollow rod <input type="checkbox"/> Jotted <input type="checkbox"/> Bored <input type="checkbox"/>
		6 USE: <input checked="" type="checkbox"/> Domestic <input type="checkbox"/> Public Supply <input type="checkbox"/> Industry <input type="checkbox"/> Irrigation <input type="checkbox"/> Air Conditioning <input type="checkbox"/> Commercial <input type="checkbox"/> Test Well <input type="checkbox"/>
		7 CASING: Threaded <input type="checkbox"/> Welded <input type="checkbox"/> Height: Above/Below Surface 1 ft. Diam. 4 in. to 72 ft. Depth Weight 11 lbs./ft. in. to ft. Depth Drive Shoe? Yes <input checked="" type="checkbox"/> No <input type="checkbox"/>
2 FORMATION		8 SCREEN: Type: ROCK Dia.: _____ Slot/Gauze _____ Length _____ Set between _____ ft. and _____ ft. Fittings: _____
CLAY	THICKNESS OF STRATUM 15	DEPTH TO BOTTOM OF STRATUM 15
CLAY + GRAVEL	20	35
SAND + GRAVEL	20	55
CLAY + GRAVEL	10	65
SHALE	5	70
SAND ROCK	15	85
SHALE	15	100
SAND ROCK	5	105
SHALE ROCK	15	120
		9 STATIC WATER LEVEL 20 ft. below land surface
		10 PUMPING LEVEL below land surface 50 ft. after 2 hrs. pumping 30 g.p.m. _____ ft. after _____ hrs. pumping _____ g.p.m.
		11 WATER QUALITY in Parts Per Million: Iron (Fe) _____ Chlorides (Cl) _____ NONE TAKEN Hardness _____ Other _____
		12 WELL HEAD COMPLETION: <input type="checkbox"/> In Approved Pit <input checked="" type="checkbox"/> Pitless Adapter <input type="checkbox"/> 12" Above Grade
		13 Well Grouted? <input type="checkbox"/> Yes <input checked="" type="checkbox"/> No <input type="checkbox"/> Neat Cement <input type="checkbox"/> Bentonite <input type="checkbox"/> Depth: From _____ ft. to _____ ft.
		14 Nearest Source of possible contamination 75 feet S Direction SEPTIC Type Well disinfected upon completion <input checked="" type="checkbox"/> Yes <input type="checkbox"/> No
		15 PUMP: <input type="checkbox"/> Not installed Manufacturer's Name RAPIDAYTON Model Number 7P27 HP 3/4 Volts 230 Length of Drop Pipe 50 ft. capacity 30 G.P.M. Type: <input checked="" type="checkbox"/> Submersible <input type="checkbox"/> Jet <input type="checkbox"/> Reciprocating
16 Remarks, elevation, source of data, etc.		17 WATER WELL CONTRACTOR'S CERTIFICATION: This well was drilled under my jurisdiction and this report is true to the best of my knowledge and belief. MARY'S & ED'S Well Drilling 1093 REGISTERED BUSINESS NAME REGISTRATION NO. Address 2082 BURTON Holt, Mich. Signed Mary's & Ed's Well Drilling Date 3-7-71 AUTHORIZED REPRESENTATIVE



WATER WELL RECORD

ACT 294 PA 1965

MICHIGAN DEPARTMENT

OF
PUBLIC HEALTH

1 LOCATION OF WELL

County <i>Ingham</i>	Township Name <i>Delhia</i>	Fraction <i>7 1/4 NE 1/4 NW 1/4</i>	Section Number <i>13</i>	Town Number <i>3</i>	Range Number <i>2 W.</i>
-------------------------	--------------------------------	--	-----------------------------	-------------------------	-----------------------------

Distance and Direction from Road Intersections
4 1/2 mi South of Willowby or Keltann

Street address & City of Well Location
Not known Kault

Locate with "X" in section below

Sketch Map:

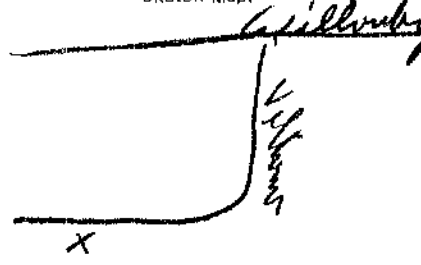
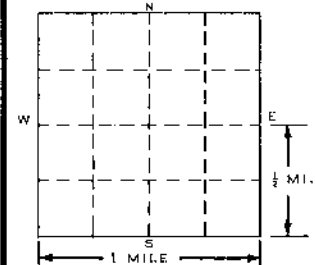

3 OWNER OF WELL: *Neal Vellomus Bldg*
Willowby ed
Kault

Address

4 WELL DEPTH: (completed) *115* ft. Date of Completion *8-21-74*

5 Cable tool Rotary Driven Dug
 Hollow rod Jetted Bored

6 USE: Domestic Public Supply Industry
 Irrigation Air Conditioning Commercial
 Test Well

7 CASING: Threaded Welded Height: Above/Below Surface *1* ft.
Weight *11* lbs./ft. Drive Shoe? Yes No

4 in. to *75* ft. Depth
in. to ft. Depth

2 FORMATION

FORMATION	THICKNESS OF STRATUM	DEPTH TO BOTTOM OF STRATUM
<i>Beaver Sand</i>	<i>30</i>	<i>30</i>
<i>Shay Sand w/ clay</i>	<i>30</i>	<i>60</i>
<i>Clay</i>	<i>15</i>	<i>75</i>
<i>Shale</i>	<i>20</i>	<i>95</i>
<i>Rob.</i>	<i>20</i>	<i>115</i>

8 SCREEN: Type: *Rock* Dia.: _____
Slot/Gauze _____ Length _____
Set between _____ ft. and _____ ft.
Fittings: _____

9 STATIC WATER LEVEL *35* ft. below land surface

10 PUMPING LEVEL below land surface *45* ft. after *1* hrs. pumping *20* g.p.m.
_____ ft. after _____ hrs. pumping _____ g.p.m.

11 WATER QUALITY in Parts Per Million
Iron (Fe) *none* Chlorides (Cl) _____
Hardness _____ Other _____

12 WELL HEAD COMPLETION: In Approved Pit
 Pitless Adapter 12" Above Grade

13 Well Grouted? Yes No
 Neat Cement Bentonite _____
Depth: From _____ ft. to _____ ft.

14 Nearest Source of possible contamination
50 feet *S* Direction *Septic* Type
Well disinfected upon completion Yes No

15 PUMP: Not installed
Manufacturer's Name *Radford*
Model Number *3-P* HP *1/3* Volts *220*
Length of Drop Pipe *60* ft. capacity *10* G.P.M.
Type: Submersible Jet Reciprocating

16 Remarks, elevation, source of data, etc.

NOTED BY OPERATOR, 1005 654
TO H

17 WATER WELL CONTRACTOR'S CERTIFICATION:

This well was drilled under my jurisdiction and this report is true to the best of my knowledge and belief.
Kenon Well
REGISTERED BUSINESS NAME
Address *Kault*
REGISTRATION NO. *0050*
Signed *Robert Kenon* Date *8-27-74*
AUTHORIZED REPRESENTATIVE

MAR 30 1976

WATER WELL RECORD
ACT 294 PA 1965

MICHIGAN DEPARTMENT
OF
PUBLIC HEALTH

1 LOCATION OF WELL

County Ingham	Township Name Delhi	Elevation 264	Section Number 13	Town Number T3	Range Number R2
-------------------------	-------------------------------	-------------------------	-----------------------------	--------------------------	---------------------------

Distance And Direction from Road Intersections
1000yds. S. of Willoughby and Veltema Sts.

Street address & City of Well Location
3763 /3770 Bush Gardens Molt, Mich. 48842

3 OWNER OF WELL: **Corneal Veltema**
Address **3805 Willoughby Molt, Mich. 48842**

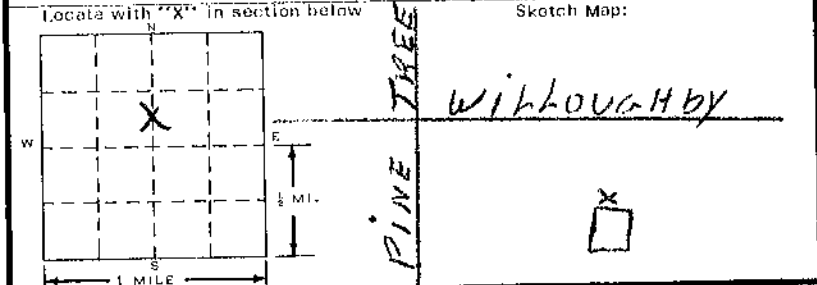

4 WELL DEPTH: (completed) **100** ft. Date of Completion **June 3, 1975**

5 Cable tool Rotary Driven Dug
 Hollow rod Jetted Bored

6 USE: Domestic Public Supply Industry
 Irrigation Air Conditioning Commercial
 Test Well

7 CASING: Threaded Welded
Diam. _____ Height: Above/Below Surface **1** ft.
4 in. to **71** ft. Depth Weight **11** lbs./ft.
_____ in. to _____ ft. Depth Drive Shou? Yes No

2 FORMATION	THICKNESS OF STRATUM	DEPTH TO BOTTOM OF STRATUM
Brown clay	10	10
Sand & gravel	10	20
Blue clay	10	30
Sand & gravel	10	40
Fine sand	20	60
Coarse gravel	10	70
Sand rock	30	100

8 SCHEEN: **Rock**
Type: _____ Dia.: _____
Slot/Gauze _____ Length _____
Set between _____ ft. and _____ ft.
Fittings: _____

9 STATIC WATER LEVEL **30** ft. below land surface

10 PUMPING LEVEL below land surface
60 ft. after **3** hrs. pumping **25** g.p.m.
_____ ft. after _____ hrs. pumping _____ g.p.m.

11 WATER QUALITY in Parts Per Million:
Iron (Fe) _____ Chlorides (Cl) _____
Hardness _____ Other **None taken**

12 WELL HEAD COMPLETION: In Approved Pit
 Pitless Adapter 12" Above Grade

13 Well Grouted? Yes No
 Neat Cement Bentonite
Depth: From _____ ft. to _____ ft.

14 Nearest Source of possible contamination
60 feet **N.** Direction **Septic** Type
Well disinfected upon completion Yes No

15 PUMP: Not installed
Manufacturer's Name **Flint & Walling**
Model Number **303** HP **1/2** Volts **230**
Length of Drop Pipe **60** ft. capacity **10** G.P.M.
Type: Submersible Jot Reciprocating

16 Remarks, elevation, source of data, etc.

ADDED INFO BY DRILLER ITEM NO.
*CORRECTED BY **ST**
**ADDITION BY
ELEVATION
DEPTH TO ROCK

17 WATER WELL CONTRACTOR'S CERTIFICATION:
This well was drilled under my jurisdiction and this report is true to the best of my knowledge and belief.
Mary's Well Drilling **1176**
REGISTERED BUSINESS NAME REGISTRATION NO.
Address **4340 Molt Rd. Molt, MI. 48842**
Signed **Mary's Well Drilling** Date **June 3, 1975**
AUTHORIZED REPRESENTATIVE

MAR 30 1976

WATER WELL RECORD
ACT 294 PA 1965

MICHIGAN DEPARTMENT
OF
PUBLIC HEALTH

1 LOCATION OF WELL		Section		Section Number	Town Number	Range Number
County Ingham	Township Name Delhi	SE 1/4	NE 1/4	13	T3 N/9.	R2 E/W.
Distance And Direction from Road Intersections 1000yds. S. of Willoughby and Veltema Sts.				3 OWNER OF WELL: Corneal Veltema		
Street address & City of Well Location 3790 Busch Gardens Molt, Mich. 48842				Address 3805 Willoughby Molt, Mich. 48842		
Locate with "X" in section below		Sketch Map:				
		4		WELL DEPTH: (completed) Date of Completion 100 ft. Aug. 21, 1975		
		5		<input type="checkbox"/> Cable tool <input checked="" type="checkbox"/> Rotary <input type="checkbox"/> Driven <input type="checkbox"/> Dug <input type="checkbox"/> Hollow rod <input type="checkbox"/> Jetted <input type="checkbox"/> Bored <input type="checkbox"/> _____		
		6		USE: <input checked="" type="checkbox"/> Domestic <input type="checkbox"/> Public Supply <input type="checkbox"/> Industry <input type="checkbox"/> Irrigation <input type="checkbox"/> Air Conditioning <input type="checkbox"/> Commercial <input type="checkbox"/> Test Well <input type="checkbox"/> _____		
		7		CASING: Threaded <input checked="" type="checkbox"/> Welded <input type="checkbox"/> Diam. _____ Height: Above/Below Surface 1 ft. 4 in. to 67 ft. Depth Weight 11 lbs./ft. _____ in. to _____ ft. Depth Drive Shoe? Yes <input checked="" type="checkbox"/> No <input type="checkbox"/>		
2		THICKNESS OF STRATUM	DEPTH TO BOTTOM OF STRATUM	8 SCREEN: Rock		
		10	10	Type: _____ Dia.: _____		
		20	30	Slot/Gauze _____ Length _____		
		20	50	Set between _____ ft. and _____ ft.		
		10	60	Fittings: _____		
		5	65	9 STATIC WATER LEVEL 30 ft. below land surface		
		35	100	10 PUMPING LEVEL below land surface		
				60 ft. after 3 hrs. pumping 25 g.p.m.		
				_____ ft. after _____ hrs. pumping _____ g.p.m.		
				11 WATER QUALITY in Parts Per Million:		
				Iron (Fe) _____ Chlorides (Cl) _____		
				None taken		
				Hardness _____ Other _____		
				12 WELL HEAD COMPLETION: <input type="checkbox"/> In Approved Pit		
				<input checked="" type="checkbox"/> Pitless Adapter <input type="checkbox"/> 12" Above Grade		
				13 Well Grouted? <input type="checkbox"/> Yes <input checked="" type="checkbox"/> No		
				<input type="checkbox"/> Neat Comont <input type="checkbox"/> Bentonite <input type="checkbox"/> _____		
				Depth: From _____ ft. to _____ ft.		
				14 Nearest Source of possible contamination		
				60 feet S Direction septic Type		
				Well disinfected upon completion <input checked="" type="checkbox"/> Yes <input type="checkbox"/> No		
				15 PUMP: <input type="checkbox"/> Not installed		
				Manufacturer's Name Flint & Walling		
				Model Number 303 HP 1/2 Volts 230		
				Length of Drop Pipe 60 ft. capacity 10 G.P.M.		
				Type: <input checked="" type="checkbox"/> Submersible		
				<input type="checkbox"/> Jot <input type="checkbox"/> Reciprocating		
USE A 2ND SHEET IF NEEDED				17 WATER WELL CONTRACTOR'S CERTIFICATION:		
16 Remarks, elevation, source of data, etc. ADDED INFO BY DRILLER ITEM NO. *CORRECTED BY **ADDITION BY ELEVATION _____ DEPTH TO ROCK _____				This well was drilled under my jurisdiction and this report is true to the best of my knowledge and belief.		
				Mary's Well Drilling 1176		
				REGISTERED BUSINESS NAME REGISTRATION NO.		
				Address 4340 Molt Rd. Molt, MI. 48842		
				Signed Date Aug. 21, 1976		
				AUTHORIZED REPRESENTATIVE		

MAR 08 1973

WATER WELL RECORD

ACT 294 PA 1965

MICHIGAN DEPARTMENT OF PUBLIC HEALTH

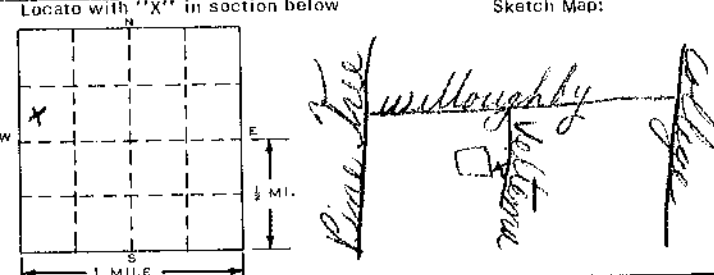
1 LOCATION OF WELL				NE NE NW	
County <i>Ingham</i>	Township Name <i>Delhi</i>	Fraction <i>NE NE NW</i>	Section Number <i>13</i>	Town Number <i>T 3 N</i>	Range Number <i>R 2 E/W.</i>
Distance and Direction from Road Intersections <i>100 yds. south of Willoughby</i>		3 OWNER OF WELL: <i>Cornial Veltema</i>			
Street address & City of Well Location <i>2471 Veltema Dr. Holt Mich. 48842</i>		Address <i>3805 E. Willoughby</i>			
Locate with "X" in section below		Holt Mich. <i>48842</i>			
Sketch Map: 		4 WELL DEPTH: (completed) <i>120</i> ft. Date of Completion <i>Sept. 7-72</i>			
2 FORMATION		THICKNESS OF STRATUM		DEPTH TO BOTTOM OF STRATUM	
		Brown clay		<i>3 3</i>	
Sand & Gravel		<i>12 15</i>		5 <input checked="" type="checkbox"/> Cable tool <input type="checkbox"/> Rotary <input type="checkbox"/> Driven <input type="checkbox"/> Dug	
Blue clay		<i>5 20</i>		<input type="checkbox"/> Hollow rod <input type="checkbox"/> Jetted <input type="checkbox"/> Bored <input type="checkbox"/>	
Sand & Gravel		<i>30 50</i>		6 USE: <input checked="" type="checkbox"/> Domestic <input type="checkbox"/> Public Supply <input type="checkbox"/> Industry	
Blue clay		<i>10 60</i>		<input type="checkbox"/> Irrigation <input type="checkbox"/> Air Conditioning <input type="checkbox"/> Commercial	
Coarse Gravel		<i>10 70</i>		<input type="checkbox"/> Test Well	
Blue clay		<i>5 75</i>		7 CASING: Threaded <input type="checkbox"/> Welded <input checked="" type="checkbox"/>	
Sand rock		<i>30 105</i>		Diam. _____ Hoigt: Above/Below	
Blue shale		<i>15 120</i>		Surface <i>1</i> ft.	
				Weight <i>11</i> lbs./ft.	
				Drive Shoe? Yes <input checked="" type="checkbox"/> No <input type="checkbox"/>	
				8 SCREEN: <i>ROCK</i>	
				Type: _____ Dia.: _____	
				Slot/Gauze _____ Length _____	
				Set between _____ ft. and _____ ft.	
				Fittings: _____	
				9 STATIC WATER LEVEL <i>14</i> ft. below land surface	
				10 PUMPING LEVEL below land surface	
				<i>50</i> ft. after <i>3</i> hrs. pumping <i>25</i> g.p.m.	
				_____ ft. after _____ hrs. pumping _____ g.p.m.	
				11 WATER QUALITY in Parts Per Million:	
				Iron (Fe) _____ Chlorides (Cl) _____	
				<i>None taken</i>	
				Hardness _____ Other _____	
				12 WELL HEAD COMPLETION: <input type="checkbox"/> In Approved Pit	
				<input checked="" type="checkbox"/> Pitless Adapter <input type="checkbox"/> 12" Above Grade	
				13 Well Grouted? <input type="checkbox"/> Yes <input checked="" type="checkbox"/> No	
				<input type="checkbox"/> Neat Cement <input type="checkbox"/> Bentonite <input type="checkbox"/>	
				Depth: From _____ ft. to _____ ft.	
				14 Nearest Source of possible contamination	
				<i>60</i> feet <i>W</i> Direction <i>septic</i> Type	
				Well disinfected upon completion <input checked="" type="checkbox"/> Yes <input type="checkbox"/> No	
				15 PUMP: <input type="checkbox"/> Not installed	
				Manufacturer's Name <i>Fleet Wellfing</i>	
				Model Number <i>303</i> HP <i>1/2</i> Volts <i>230</i>	
				Length of Drop Pipe <i>50</i> ft. capacity <i>25</i> G.P.M.	
				Type: <input checked="" type="checkbox"/> Submersible	
				<input type="checkbox"/> Jet <input type="checkbox"/> Reciprocating	
16 Remarks, elevation, source of data, etc. ADDED INFO. BY DRILLER, ITEM NO. CORRECTED BY <i>[Signature]</i> ADDITION <i>[Signature]</i>		17 WATER WELL CONTRACTOR'S CERTIFICATION:			
		This well was drilled under my jurisdiction and this report is true to the best of my knowledge and belief. <i>Morris Well Drilling 1176</i> REGISTERED BUSINESS NAME REGISTRATION NO. Address <i>4340 Holt Rd. Holt Mich. 48842</i> Signed <i>Morris Well Drilling</i> Date <i>Sept. 7, 1972</i> AUTHORIZED REPRESENTATIVE			



MAR 08 1973

WATER WELL RECORD

ACT 294 PA 1966

MICHIGAN DEPARTMENT OF PUBLIC HEALTH

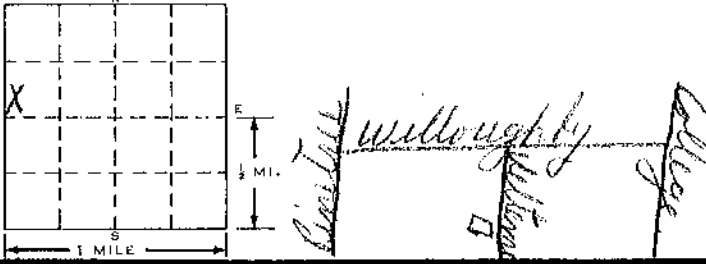
1 LOCATION OF WELL			<i>NE 1/4 NW 1/4</i>		
County <i>Ingham</i>	Township Name <i>Delhi</i>	Fraction <i>NE 1/4 SW 1/4 SE 1/4</i>	Section Number <i>13</i>	Town Number <i>T3 N/O</i>	Range Number <i>R2 W.</i>
Distance And Direction from Road Intersections <i>150 yds south of Willoughby</i> <i>2463 Veltema Dr. Holt, Mich 48842</i>			3 OWNER OF WELL: <i>Cornel Veltema</i> Address <i>3805 E. Willoughby</i> <i>Holt, Mich. 48842</i>		
Street address & City of Well Location Locate with "X" in section below			4 WELL DEPTH: (completed) Date of Completion <i>125</i> ft. <i>12-15-72</i>		
Sketch Map: 			5 <input checked="" type="checkbox"/> Cable tool <input type="checkbox"/> Rotary <input type="checkbox"/> Driven <input type="checkbox"/> Dug <input type="checkbox"/> Hollow rod <input type="checkbox"/> Jetted <input type="checkbox"/> Bored <input type="checkbox"/>		
			6 USE: <input checked="" type="checkbox"/> Domestic <input type="checkbox"/> Public Supply <input type="checkbox"/> Industry <input type="checkbox"/> Irrigation <input type="checkbox"/> Air Conditioning <input type="checkbox"/> Commercial <input type="checkbox"/> Test Well <input type="checkbox"/>		
2 FORMATION			7 CASING: Threaded <input type="checkbox"/> Welded <input type="checkbox"/> Height: Above/Below Diam. _____ Surface <i>1</i> ft. <i>4</i> in. to <i>83</i> ft. Depth Weight <i>11</i> lbs./ft. _____ in. to _____ ft. Depth Drive Shoe? Yes <input checked="" type="checkbox"/> No <input type="checkbox"/>		
			8 SCREEN: Type: <i>ROCK</i> Dia.: _____ Slot/Gauze _____ Length _____ Set between _____ ft. and _____ ft. Fittings: _____		
Brown Clay			9 STATIC WATER LEVEL <i>14</i> ft. below land surface		
Thin sand			10 PUMPING LEVEL below land surface <i>50</i> ft. after <i>3</i> hrs. pumping <i>25</i> g.p.m. _____ ft. after _____ hrs. pumping _____ g.p.m.		
Sand & Gravel			11 WATER QUALITY in Parts Per Million: Iron (Fe) _____ Chlorides (Cl) _____ <i>none taken</i> Hardness _____ Other _____		
Coarse gravel			12 WELL HEAD COMPLETION: <input type="checkbox"/> In Approved Pit <input checked="" type="checkbox"/> Pitless Adapter <input type="checkbox"/> 12" Above Grade		
Sand & gravel			13 Well Grouted? <input type="checkbox"/> Yes <input checked="" type="checkbox"/> No <input type="checkbox"/> Neat Cement <input type="checkbox"/> Bentonite <input type="checkbox"/> _____ Depth: From _____ ft. to _____ ft.		
Blue Clay			14 Nearest Source of possible contamination <i>65</i> feet <i>W</i> Direction <i>Septic</i> Type _____ Wall disinfected upon completion <input checked="" type="checkbox"/> Yes <input type="checkbox"/> No		
Sand & gravel			15 PUMP: <input type="checkbox"/> Not installed Manufacturer's Name <i>Flint Wellling</i> Model Number <i>303</i> HP <i>1/2</i> Volts <i>230</i> Length of Drop Pipe <i>50</i> ft. capacity <i>25</i> G.P.M. Type: <input checked="" type="checkbox"/> Submersible <input type="checkbox"/> Jet <input type="checkbox"/> Reciprocating		
Sand rock			16 Remarks, elevation, source of data, etc. ADDED INFO. BY DRILLER, ITEM NO. _____ CORRECTED BY: _____ ADDITION: _____		
USE A 2ND SHEET IF NEEDED			17 WATER WELL CONTRACTOR'S CERTIFICATION: This well was drilled under my jurisdiction and this report is true to the best of my knowledge and belief. <i>Marshall Wellling</i> <i>1176</i> REGISTERED BUSINESS NAME REGISTRATION NO. Address <i>4340 No 4 Rd. Holt, Mich.</i> Signed <i>Marshall Wellling</i> Date <i>12-15-72</i> AUTHORIZED REPRESENTATIVE		

MAY 16 1976

WATER WELL RECORD

ACT 294 PA 1965

SE NE NW

MICHIGAN DEPARTMENT OF PUBLIC HEALTH

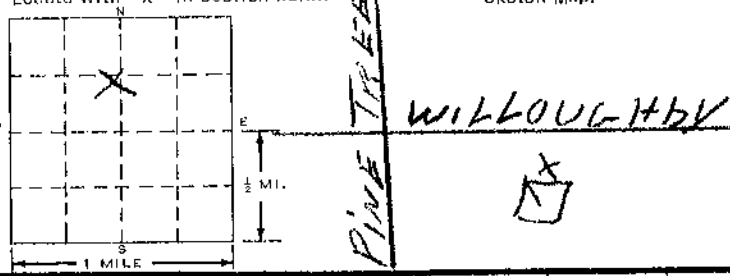
1 LOCATION OF WELL																									
County: Ingham		Township Name: Delhi		Fraction: <i>SE NE NW</i>		Section Number: 13		Town Number: T3 N/9		Range Number: R2 E/W.															
Distance and Direction from Road Intersections: 1000yds. S. of Willoughby & Veltema St. 3785 Bush Gardens, Holt, Mich.				3 OWNER OF WELL: Corneal Veltema Address: 3805 Willoughby Holt, Mich.																					
Street address & City of Well Location Locate with "X" in section below				Sketch Map: <i>PINE TREE</i> <i>WILLOUGHBY</i> 				4 WELL DEPTH: (completed) 100 ft. Date of Completion																	
<table border="1" style="width: 100%; border-collapse: collapse;"> <tr> <th style="width: 30%;">2 FORMATION</th> <th style="width: 15%;">THICKNESS OF STRATUM</th> <th style="width: 15%;">DEPTH TO BOTTOM OF STRATUM</th> </tr> <tr> <td>Brown clay</td> <td>10</td> <td>10</td> </tr> <tr> <td>Sand & gravel</td> <td>10</td> <td>20</td> </tr> <tr> <td>Blue clay</td> <td>20</td> <td>40</td> </tr> <tr> <td>Sand & gravel</td> <td>25</td> <td>65</td> </tr> <tr> <td>Sand rock</td> <td>35</td> <td>100</td> </tr> </table>				2 FORMATION	THICKNESS OF STRATUM	DEPTH TO BOTTOM OF STRATUM	Brown clay	10	10	Sand & gravel	10	20	Blue clay	20	40	Sand & gravel	25	65	Sand rock	35	100	5 <input type="checkbox"/> Cable tool <input checked="" type="checkbox"/> Rotary <input type="checkbox"/> Driven <input type="checkbox"/> Dug <input type="checkbox"/> Hollow rod <input type="checkbox"/> Jatted <input type="checkbox"/> Bored <input type="checkbox"/>			
				2 FORMATION	THICKNESS OF STRATUM	DEPTH TO BOTTOM OF STRATUM																			
				Brown clay	10	10																			
				Sand & gravel	10	20																			
				Blue clay	20	40																			
Sand & gravel	25	65																							
Sand rock	35	100																							
6 USE: <input checked="" type="checkbox"/> Domestic <input type="checkbox"/> Public Supply <input type="checkbox"/> Industry <input type="checkbox"/> Irrigation <input type="checkbox"/> Air Conditioning <input type="checkbox"/> Commercial <input type="checkbox"/> Test Well <input type="checkbox"/>																									
7 CASING: Threaded <input checked="" type="checkbox"/> Welded <input type="checkbox"/> Diam. _____ Height: Above/Below Surface 1 ft. Weight 11 lbs./ft. Drive Shoe? Yes <input checked="" type="checkbox"/> No <input type="checkbox"/>																									
8 SCREEN: Rock Type: _____ Dia.: _____ Slot/Gauze _____ Length _____ Set between _____ ft. and _____ ft. Fittings: _____																									
9 STATIC WATER LEVEL: 30 ft. below land surface																									
10 PUMPING LEVEL below land surface 60 ft. after 3 hrs. pumping 25 g.p.m. _____ ft. after _____ hrs. pumping _____ g.p.m.																									
11 WATER QUALITY in Parts Per Million: Iron (Fe) _____ Chlorides (Cl) _____ Hardness _____ Other None taken																									
12 WELL HEAD COMPLETION: <input type="checkbox"/> In Approved Pit <input checked="" type="checkbox"/> Pitless Adapter <input type="checkbox"/> 12" Above Grade																									
13 Wall Grouted? <input type="checkbox"/> Yes <input checked="" type="checkbox"/> No <input type="checkbox"/> Neat Cement <input type="checkbox"/> Bentonite _____ Depth: From _____ ft. to _____ ft.																									
14 Nearest Source of possible contamination 70 foot S. Direction Septic Type Well disinfected upon completion <input checked="" type="checkbox"/> Yes <input type="checkbox"/> No																									
15 PUMP: <input type="checkbox"/> Not installed Manufacturer's Name Flint & Walling Model Number 303 HP 1/2 Volts 230 Length of Drop Pipe 60 ft. capacity 10 G.P.M. Type: <input checked="" type="checkbox"/> Submersible <input type="checkbox"/> Jet <input type="checkbox"/> Reciprocating																									
16 Remarks, elevation, source of data, etc. ADDED INFO BY DRILLER, ITEM NO. *CORRECTED BY <i>V7</i> **ADDITION BY _____ ELEVATION _____ DEPTH TO ROCK _____																									
17 WATER WELL CONTRACTOR'S CERTIFICATION: This well was drilled under my jurisdiction and this report is true to the best of my knowledge and belief. Marv's Well Drilling 1178 REGISTERED BUSINESS NAME REGISTRATION NO. Address 4340 Holt Rd. Holt, Mi. 48842 Signed <i>Marvin Mullins</i> Date 3/29/76 AUTHORIZED REPRESENTATIVE																									

2 DEC 19 1975

WATER WELL RECORD
ACT 294 PA 1965

MICHIGAN DEPARTMENT
OF
PUBLIC HEALTH

1 LOCATION OF WELL

County INGHAM	Township Name Dellhi	Fraction 1/4 NE 1/4	Section Number 13	Town Number 3D N/S	Range Number 2 E/W
-------------------------	--------------------------------	-------------------------------	-----------------------------	------------------------------	------------------------------

Distance And Direction from Road Intersections
1/4 mi S. of Willoby on VETTER DR. South side of road

Street address & City of Well Location
14017 Millh.

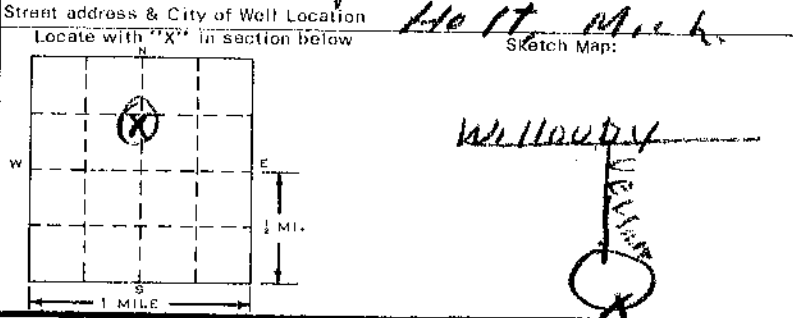

3 OWNER OF WELL: **N. VELTMA**
Address: **Willoby RD HOIT**

4 WELL DEPTH: (completed) **118** ft. Date of Completion **3-15-75**

5 Cable tool Rotary Driven Dug
 Hollow rod Jetted Bored

6 USE: Domestic Public Supply Industry
 Irrigation Air Conditioning Commercial
 Test Well

7 CASING: Threaded Welded Diam. _____
Height: Above/Below Surface _____ ft.
Weight _____ lbs./ft.
Drive Shoe? Yes No

2 FORMATION	THICKNESS OF STRATUM	DEPTH TO BOTTOM OF STRATUM
Clay & Sand	30	30
Gravel	20	50
Gravel & Clay	30	80
Rock	28	118

8 SCREEN: Type: **Rock** Dia.: _____
Slot/Gauze _____ Length _____
Set between _____ ft. and _____ ft.
Fittings: _____

9 STATIC WATER LEVEL: **35** ft. below land surface

10 PUMPING LEVEL below land surface:
35 ft. after **1** hrs. pumping **20** g.p.m.
_____ ft. after _____ hrs. pumping _____ g.p.m.

11 WATER QUALITY in Parts Per Million:
Iron (Fe) _____ Chlorides (Cl) _____
Hardness _____ Other _____

12 WELL HEAD COMPLETION: In Approved Pit
 Pitless Adapter 12" Above Grade

13 Well Grouted? Yes No
 Neat Cement Bentonite _____
Depth: From _____ ft. to _____ ft.

14 Nearest Source of possible contamination:
50 feet **S** Direction **SEPTIC** Type
Well disinfected upon completion Yes No

15 PUMP: Not installed
Manufacturer's Name **RAPIDAYTON**
Model Number **3P27** HP **1/3** Volts **220**
Length of Drop Pipe **60** ft. capacity **20** G.P.M.
Type: Submersible Jet Reciprocating

16 Remarks, elevation, source of data, etc.
ADDED INFO BY DRILLER, ITEM NO.,
* CORRECTED BY **ST**
** ADDITION BY **ST**
ELEVATION _____
DEPTH TO ROCK _____

17 WATER WELL CONTRACTOR'S CERTIFICATION:
This well was drilled under my jurisdiction and this report is true to the best of my knowledge and belief.
LEWIS WELL **0050**
REGISTERED BUSINESS NAME REGISTRATION NO.
Address **HOIT**
Signed **S. J. Lewis** Date **3-20-75**
AUTHORIZED REPRESENTATIVE

2 NOV 2 1977

WATER WELL RECORD
ACT 294 PA 1966

MICHIGAN DEPARTMENT
OF
PUBLIC HEALTH

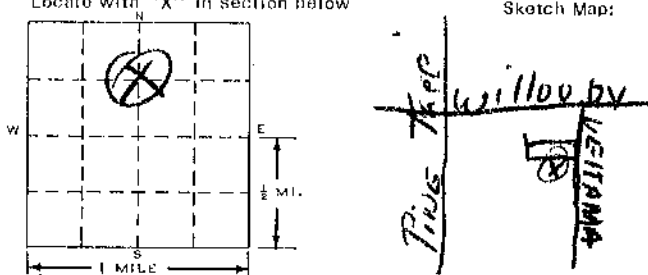
1 LOCATION OF WELL		
County INGHAM	Township Name DELHI	Fraction NW 1/4 NW 1/4 NE 1/4
Distance And Direction from Road Intersections 500ft South of Willowby on VELTEMA DR. WEST SIDE		Section Number 13
Street address & City of Well Location VELTEMA DR HOLT,		Town Number 3 N/A
Locate with "X" in section below 		Range Number 20 W.
3 OWNER OF WELL: VELTEMA, C. BLDG		
Address 3805 Willowby HOLT, Mich		
4 WELL DEPTH: (completed) 110 ft. Date of Completion 4-20-74		
5 <input checked="" type="checkbox"/> Cable tool <input type="checkbox"/> Rotary <input type="checkbox"/> Driven <input type="checkbox"/> Dug <input type="checkbox"/> Hollow rod <input type="checkbox"/> Jetted <input type="checkbox"/> Bored <input type="checkbox"/>		
6 USE: <input checked="" type="checkbox"/> Domestic <input type="checkbox"/> Public Supply <input type="checkbox"/> Industry <input type="checkbox"/> Irrigation <input type="checkbox"/> Air Conditioning <input type="checkbox"/> Commercial <input type="checkbox"/> Test Well <input type="checkbox"/>		
7 CASING: Threaded <input checked="" type="checkbox"/> Welded <input type="checkbox"/> Diam. _____ Height: Above/Below Surface 1 ft. 4 in. to 20 ft. Depth Weight 11 lbs./ft. Drive Shoe? Yes <input checked="" type="checkbox"/> No <input type="checkbox"/>		
8 SCREEN:		
Type: Rock Dia.: _____		
Slot/Gauze _____ Length _____		
Set between _____ ft. and _____ ft.		
Fittings: _____		
9 STATIC WATER LEVEL 20 ft. below land surface		
10 PUMPING LEVEL below land surface 20 ft. after 2 hrs. pumping 30 g.p.m.		
_____ ft. after _____ hrs. pumping _____ g.p.m.		
11 WATER QUALITY in Parts Per Million:		
Iron (Fe) _____ Chlorides (Cl) _____		
None taken		
Hardness _____ Other _____		
12 WELL HEAD COMPLETION: <input type="checkbox"/> In Approved Pit <input checked="" type="checkbox"/> Pitless Adapter <input type="checkbox"/> 12" Above Grade		
13 Well Grouted? <input type="checkbox"/> Yes <input checked="" type="checkbox"/> No <input type="checkbox"/> Neat Cement <input type="checkbox"/> Bentonite <input type="checkbox"/>		
Depth: From _____ ft. to _____ ft.		
14 Nearest Source of possible contamination 50 feet W Direction Set Type _____		
Well disinfected upon completion <input checked="" type="checkbox"/> Yes <input type="checkbox"/> No		
15 PUMP: <input type="checkbox"/> Not installed		
Manufacturer's Name GOULDS		
Model Number 5A 2W HP 1/2 Volts 220		
Length of Drop Pipe 40 ft. capacity 20 g.p.m.		
Type: <input checked="" type="checkbox"/> Submersible <input type="checkbox"/> Jet <input type="checkbox"/> Reciprocating		
USE A 2ND SHEET IF NEEDED		
16 Remarks, elevation, source of data, etc.		17 WATER WELL CONTRACTOR'S CERTIFICATION:
INFO BY DRILLER, ITEM NO. _____ PROVIDED BY _____ ADDRESS BY _____ ELEVATION _____ DEPTH TO ROCK _____		This well was drilled under my jurisdiction and this report is true to the best of my knowledge and belief. LENON WELL 0050 REGISTERED BUSINESS NAME REGISTRATION NO. Address Holt Signed Lenon Well Date 4-20-74 AUTHORIZED REPRESENTATIVE

NOV 01 1978

WATER WELL RECORD

ACT 294 PA 1965

MICHIGAN DEPARTMENT OF PUBLIC HEALTH

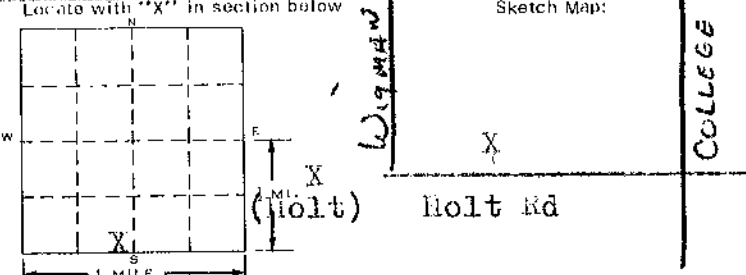
1 LOCATION OF WELL		Fraction		Section Number		Town Number		Range Number	
County <u>Ingham</u>		Township Name <u>Delhi</u>		<u>SE 1/4 SW 1/4</u>		<u>13</u>		<u>3N 7W</u>	
Distance And Direction from Road Intersections <u>1/2 mile west of college rd on the north side of Holt Rd.</u>				3 OWNER OF WELL: Address <u>Robt Phelps Holt Rd Holt Mich</u>					
Street address & City of Well Location <u>Holt Rd Holt,</u>				4 WELL DEPTH: (completed) Date of Completion <u>120</u> ft. <u>7/19/78</u>					
Locate with "X" in section below 				5 <input type="checkbox"/> Cable tool <input checked="" type="checkbox"/> Rotary <input type="checkbox"/> Driven <input type="checkbox"/> Dug <input type="checkbox"/> Hollow rod <input type="checkbox"/> Jotted <input type="checkbox"/> Bored <input type="checkbox"/>					
				6 USE: <input checked="" type="checkbox"/> Domestic <input type="checkbox"/> Public Supply <input type="checkbox"/> Industry <input type="checkbox"/> Irrigation <input type="checkbox"/> Air Conditioning <input type="checkbox"/> Commercial <input type="checkbox"/> Test Well <input type="checkbox"/>					
				7 CASING: Threaded <input checked="" type="checkbox"/> Welded <input type="checkbox"/> Height: Above/Below Diam. <u>4</u> in. to <u>82</u> ft. Depth Surface <u>1</u> ft. <u>82</u> in. to _____ ft. Depth Weight <u>11</u> lbs./ft. Drive Shoe? Yes <input checked="" type="checkbox"/> No <input type="checkbox"/>					
2 FORMATION		THICKNESS OF STRATUM		DEPTH TO BOTTOM OF STRATUM		8 SCREEN: Type <u>Rock</u> Dia.: _____ Slot/Gauze _____ Length _____ Set between _____ ft. and _____ ft. Fittings: _____			
<u>Clay</u>		<u>30</u>		<u>30</u>		9 STATIC WATER LEVEL <u>30</u> ft. below land surface			
<u>Sand & Gravel</u>		<u>52</u>		<u>82</u>		10 PUMPING LEVEL below land surface <u>40</u> ft. after <u>1/4</u> hrs. pumping <u>30</u> a.p.m. _____ ft. after _____ hrs. pumping _____ g.p.m.			
<u>Rock</u>		<u>38</u>		<u>120</u>		11 WATER QUALITY in Parts Per Million: Iron (Fe) _____ Chlorides (Cl) _____ Hardness _____ Other _____			
				12 WELL HEAD COMPLETION: <input type="checkbox"/> In Approved Pit <input type="checkbox"/> Pitless Adapter <input type="checkbox"/> 12" Above Grade					
				13 Well Grouted? <input type="checkbox"/> Yes <input type="checkbox"/> No <input type="checkbox"/> Neat Cement <input checked="" type="checkbox"/> Bentonite <input type="checkbox"/> Depth: From _____ ft. to _____ ft.					
				14 Nearest Source of possible contamination <u>70</u> feet <u>N</u> Direction <u>Septic</u> Type Well disinfected upon completion <input type="checkbox"/> Yes <input type="checkbox"/> No					
				15 PUMP: <input type="checkbox"/> Not installed Manufacturer's Name <u>F&W</u> Model Number <u>088805</u> HP <u>1/2</u> Volts <u>115</u> Length of Drop Pipe <u>42</u> ft. capacity <u>10</u> G.P.M. Type: <input checked="" type="checkbox"/> Submersible <input type="checkbox"/> Jet <input type="checkbox"/> Reciprocating					
16 Remarks, elevation, source of data, etc. *CORRECTED INFO BY DRILLER, ITEM NO. <u>vt</u> **ADDITION BY <u>vt</u> ELEVATION DEPTH TO ROCK				17 WATER WELL CONTRACTOR'S CERTIFICATION: This well was drilled under my jurisdiction and this report is true to the best of my knowledge and belief. <u>Lenon</u> <u>005</u> REGISTERED BUSINESS NAME REGISTRATION NO. Address <u>Holt</u> Signed <u>[Signature]</u> Date <u>7/19/78</u> AUTHORIZED REPRESENTATIVE					

MAY 16 1978

WATER WELL RECORD

ACT 294 PA 1965

SE NENE NW

MICHIGAN DEPARTMENT OF PUBLIC HEALTH

1 LOCATION OF WELL

County: Ingham Township Name: Delhi Fraction: SE NENE NW Section Number: 13 Town Number: T3 N/A Range Number: R2 N/W

Distance And Direction from Road Intersections
1000yds. S. of Willoughby and Veltema Sts.
 Street address & City of Well Location: 3795 Bush Gardens Molt, Mich. 48842

3 OWNER OF WELL:
 Address: Corneal Veltema 3805 Willoughby Molt, Mich. 48842

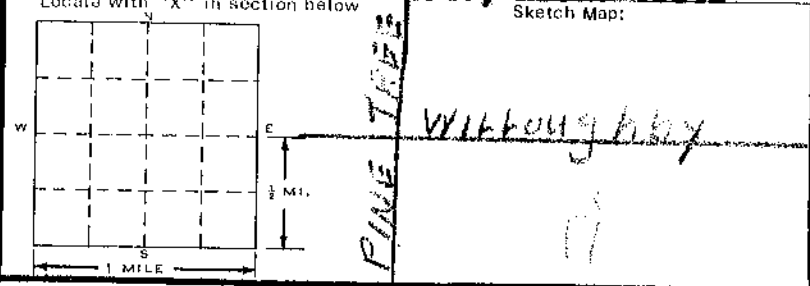

4 WELL DEPTH: (completed) Date of Completion
100 ft. March 24, 1978

5 Cable tool Rotary Driven Dug
 Hollow rod Jetted Bored

6 USE: Domestic Public Supply Industry
 Irrigation Air Conditioning Commercial
 Test Well

7 CASING: Threaded Welded Height: Above/Below Surface 1 ft.
 Weight 11 lbs./ft. Drive Shoe? Yes No

2 FORMATION

FORMATION	THICKNESS OF STRATUM	DEPTH TO BOTTOM OF STRATUM
Brown clay	10	10
Sand & gravel	20	30
Blue clay	20	50
Fine sand	15	65
Coarse rock	5	70
Sand rock	30	100

8 SCREEN: Rock
 Type: _____ Dia.: _____
 Slot/Gauze _____ Length _____
 Set between _____ ft. and _____ ft.
 Fittings: _____

9 STATIC WATER LEVEL
30 ft. below land surface

10 PUMPING LEVEL below land surface
60 ft. after 3 hrs. pumping 35 g.p.m.
 _____ ft. after _____ hrs. pumping _____ g.p.m.

11 WATER QUALITY in Parts Per Million:
 Iron (Fe) _____ Chlorides (Cl) _____
None taken
 Hardness _____ Other _____

12 WELL HEAD COMPLETION: In Approved Pit
 Pitless Adapter 12" Above Grade

13 Well Grouted? Yes No
 Neat Cement Bentonite
 Depth: From _____ ft. to _____ ft.

14 Nearest Source of possible contamination
60 feet S. Direction septic Type _____
 Well disinfected upon completion Yes No

15 PUMP: Not installed
 Manufacturer's Name Flint & Walling
 Model Number 303 HP 1/2 Volt 230
 Length of Drop Pipe 60 ft. capacity 10 G.P.M.
 Type: Submersible Jet Reciprocating

16 Remarks, elevation, source of data, etc.
 ADDED INFO BY DRILLER, ITEM NO.
 *CORRECTED BY VF
 **ADDITION BY _____
 ELEVATION _____
 DEPTH TO ROCK _____

17 WATER WELL CONTRACTOR'S CERTIFICATION:
 This well was drilled under my jurisdiction and this report is true to the best of my knowledge and belief.
Mary's Well Drilling 1176
 REGISTERED BUSINESS NAME REGISTRATION NO.
 Address 4340 Molt Rd. Molt, Mich. 48842
 Signed Marcus M. Madala Date 3/29/78
 AUTHORIZED REPRESENTATIVE

WATER WELL AND PUMP RECORD

PART 127 ACT 368, P.A. 1978

--	--	--	--	--	--

PERMIT NUMBER

1 LOCATION OF WELL

County: Ingham Township Name: Delhi Fraction: 1/4 Section Number: 13 Town Number: 3 NWS Range Number: 2 EW

Distance and Direction From Road Intersection: _____

Street Address & City of Well Location: Hault Rd. Hault.

Locate with "X" in Section Below

3 OWNER OF WELL: ERIC Stogenwald
 Address: Hault Rd. Hault.

Address Same As Well Location? Yes No

4 WELL DEPTH: (completed) 120 ft. Date of Completion: 5-5-83

5 Cable tool Rotary Driven Dug
 Hollow rod Auger Jotted

6 USE: Domestic Type I Public Type III Public
 Irrigation Type IIa Public Heat pump
 Test Well Type IIb Public

7 CASING: Steel Threaded Height: Above/Below
 Plastic Welded
 Diameter: 5 in. to 82 ft. depth Surface: 1 ft
4 3/4 in. to 120 ft. depth Weight: 502 1/2 lbs./ft.
 Grouted Drill Hole Diameter: _____ in. to _____ ft. depth Drive Shoe Yes No
 _____ in. to _____ ft. depth

2 FORMATION DESCRIPTION

FORMATION DESCRIPTION	THICKNESS OF STRATUM	DEPTH TO BOTTOM OF STRATUM
<u>Brown Clay</u>	<u>20</u>	<u>20</u>
<u>Brown Sand</u>	<u>10</u>	<u>30</u>
<u>Grey Sand & Gravel</u>	<u>10</u>	<u>40</u>
<u>Sand Pack & Sand.</u>	<u>40</u>	<u>80</u>
<u>Rock.</u>	<u>40</u>	<u>120</u>

8 SCREEN Not Installed

Type: Rock Diameter: _____
 Slot/Gauze: _____ Length: _____
 Set between _____ ft. and _____ ft.

FITTINGS K-Packer Lead Packer Bromer Check
 Blank above screen: _____ ft. Other: _____

9 STATIC WATER LEVEL: 30 ft. below land surface Flow

10 PUMPING LEVEL: below land surface
30 ft. after 4 hrs pumping at 30 G.P.M.
 _____ ft. after _____ hrs pumping at _____ G.P.M.

11 WELL HEAD COMPLETION Pitless adapter 12" above grade
 Basement offset Approved pit

12 WELL GROUTED? No Yes From _____ to _____ ft.
 Neat cement Bentonite Other _____
 No. of bags of cement: _____ Additives: _____

13 Nearest source of possible contamination
 Type: Septic Distance: 25 ft. Direction: N.
 Well disinfected upon completion? Yes No

14 PUMP: Not Installed Pump Installation Only
 Manufacturer's name: McDonald
 Model number: 3600 HP: 1/2 Volts: 115
 Length of Drop Pipe: 60 ft. capacity: 10 G.P.M.
 TYPE: Submersible Jet
PRESSURE TANK:
 Manufacturer's name: _____
 Model number: _____ Capacity: _____ Gallons

ADDED INFO BY DRILLER, ITEM NO. _____
 *CORRECTED BY _____
 **ADDITION BY _____
 ELEVATION _____
 DEPTH TO ROCK _____

RECEIVED
 Mich. Dept. of Public Health
 MAY 11 1983

15. Remarks, elevation, source of data, etc.
 Environmental and Occupational Health Services Administration

16. WATER WELL CONTRACTOR'S CERTIFICATION:
 This well was drilled under my jurisdiction and this report is true to the best of my knowledge and belief.

Denon REGISTERED BUSINESS NAME 0050 REGISTRATION NO.
 Address: Hault
 Signed: Harriet Denon Date: 5-3-83
 AUTHORIZED REPRESENTATIVE

WATER WELL AND PUMP RECORD

--	--	--	--	--	--	--	--

PERMIT NUMBER

1 LOCATION OF WELL		
County <i>Ingham</i>	Township Name <i>Delhi</i>	Fraction <i>1/4</i>
		Section Number <i>13</i>
		Town Number <i>3</i> NYS
		Range Number <i>2</i> EW
Distance And Direction From Road Intersection <i>Pine Tree at Dead end to 96 on East</i>		
Street Address & City of Well Location <i>Pine Tree Rd. Lansing</i>		
Address Same As Well Location? <input checked="" type="checkbox"/> Yes <input type="checkbox"/> No		
4 WELL DEPTH: (completed) <i>125</i> ft. Date of Completion <i>9-13-83</i>		
5 <input type="checkbox"/> Cable tool <input checked="" type="checkbox"/> Rotary <input type="checkbox"/> Driven <input type="checkbox"/> Dug <input type="checkbox"/> Hollow rod <input type="checkbox"/> Auger <input type="checkbox"/> Jotted <input type="checkbox"/>		
6 USE: <input checked="" type="checkbox"/> Domestic <input type="checkbox"/> Type I Public <input checked="" type="checkbox"/> Type III Public <input type="checkbox"/> Irrigation <input type="checkbox"/> Type IIa Public <input type="checkbox"/> Heat pump <input type="checkbox"/> Test Well <input type="checkbox"/> Type IIb Public <input type="checkbox"/>		
7 CASING: Diameter <input type="checkbox"/> Steel <input type="checkbox"/> Threaded <input type="checkbox"/> Welded <input checked="" type="checkbox"/> Plastic <input type="checkbox"/> Height: Above/Below <i>5</i> in. to <i>69</i> ft. depth Surface <i>1</i> ft. Weight _____ lbs./ft. Drive Shoe <input checked="" type="checkbox"/> Yes <input type="checkbox"/> No		
8 SCREEN: <input type="checkbox"/> Not Installed Type _____ Diameter _____ Slot/Gauze _____ Length _____ Set between _____ ft and _____ ft. FITTINGS: <input type="checkbox"/> K-Packer <input type="checkbox"/> Lead Packer <input type="checkbox"/> Bremer Check <input type="checkbox"/> Blank above screen _____ ft. Other _____		
9 STATIC WATER LEVEL: <i>37</i> ft. below land surface <input type="checkbox"/> Flow		
10 PUMPING LEVEL: below land surface <i>100</i> ft. after <i>3</i> hrs. pumping at <i>30</i> G.P.M. _____ ft. after _____ hrs. pumping at _____ G.P.M.		
11 WELL HEAD COMPLETION: <input checked="" type="checkbox"/> Pitless adapter <input checked="" type="checkbox"/> 12' above grade <input type="checkbox"/> Basement offset <input type="checkbox"/> Approved pit		
12 WELL GROUTED? <input type="checkbox"/> No <input checked="" type="checkbox"/> Yes From <i>0</i> to <i>69</i> ft. <input type="checkbox"/> Neat cement <input checked="" type="checkbox"/> Bentonite <input type="checkbox"/> Other _____ No. of bags of cement _____ Additives _____		
13 Nearest source of possible contamination Type <i>Septic</i> Distance <i>100</i> ft. Direction <i>West</i> Well disinfected upon completion? <input checked="" type="checkbox"/> Yes <input type="checkbox"/> No		
14 PUMP: <input type="checkbox"/> Not Installed <input type="checkbox"/> Pump Installation Only Manufacturer's name <i>McDonald</i> Model number _____ HP <i>1/2</i> Volts <i>230</i> Length of Drop Pipe <i>63</i> ft. capacity <i>10</i> G.P.M. TYPE: <input checked="" type="checkbox"/> Submersible <input type="checkbox"/> Jet PRESSURE TANK Manufacturer's name <i>Wellcraft</i> Model number <i>203</i> Capacity <i>8</i> Gallons		
15. Remarks, elevation, source of data, etc.		
16. WATER WELL CONTRACTOR'S CERTIFICATION: This well was drilled under my jurisdiction and this report is true to the best of my knowledge and belief. <i>Johnson Well Drilling 0327</i> REGISTERED BUSINESS NAME _____ REGISTRATION NO. <i>57</i> Address <i>16440 Colman Rd S. F.</i> Signed <i>Morris Johnson 11-3-84</i> Date _____ AUTHORIZED REPRESENTATIVE		

RECEIVED
 Mich. Dept. of Public Health
 NOV 26 1984
 Bureau of Environmental and
 Occupational Health - GWOS

USE A 2ND SHEET IF NEEDED

Authority: Act 368 PA 1978
 Completion: Required
 Penalty: Conviction of a violation of any provision is a misdemeanor.